

i NOTE

Lower the scraper to the ground to remove the snow.

▲ WARNING

Keep bystanders a safe distance from the machine.

▲ WARNING

Examine the work area. Remove all stones, sticks, wire, bones, and other debris that can ricochet because of the rotating impeller.

10.5 SELF PROPELLED DRIVE MODE**To start drive system:**

1. Push the ON/OFF button (6).
2. Depress and hold the drive paddle (1).
3. To increase the drive speed, push the drive speed control lever forwards (5).
4. To decrease the drive speed, pull the drive speed control lever backwards (5).

To stop the drive system:

1. Release the drive paddle (1).

i NOTE

If machine is left idle, in either operation for longer than 5 seconds, you will need to start the process over again.

To turn left:

1. Depress and hold the drive paddle (1).
2. Pull the left zero turn trigger to turn the machine to left.

To turn right:

1. Depress and hold the drive paddle (1).
2. Pull the right zero turn trigger to turn the machine to right.

i NOTE

For self propelled drive mode, this machine provides with 3 forward speeds and 1 reverse.

10.6 START AUGER AND SELF-PROPELLED DRIVE AT THE SAME TIME

1. Push the ON/OFF button (6).
2. Depress and hold the auger engagement paddle (1) to start the auger.
3. Depress and hold the drive paddle (1) to start self-propelled drive.

i NOTE

Finish these 3 actions within 5 seconds.

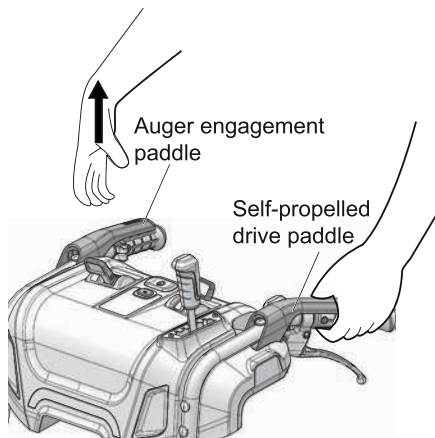
10.7 LOCK SELF-PROPELLED DRIVE PADDLE AND AUGER ENGAGEMENT PADDLE WITH ONE HAND

When you push the self-propelled drive paddle (1) and the auger engagement paddle (3) at the same time, the auger engagement paddle will be temporarily locked.

Release the auger engagement paddle (right hand) and the auger engagement paddle (3) will remain engaged.

This feature allows you to adjust the auger speed, self-propelling speed, and discharging direction of the snow while the auger rotates.

To stop the auger, release the self-propelled drive paddle and both the auger and the self-propel function will stop.

10.8 MANUALLY MOVE THE MACHINE**i NOTE**

When the pushing resistance of the whole machine becomes large or cannot be pushed, the user needs to check whether the unilateral wheel can be turned by hand when it is off the ground. If it can't be rotated easily, you need to disassemble the chassis bottom plate and unplug the motor cable. Manual promotion can be resumed at this time.

1. Unscrew the eight screws.
2. Remove the bottom chassis plate.

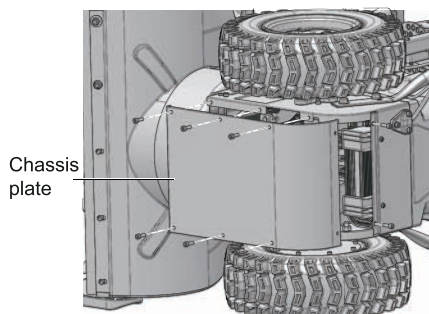

Chassis
plate

3. Unplug the motor cable.
4. Reinstall the bottom plate with eight screws.
5. Manually push the machine to move.

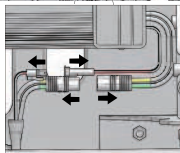
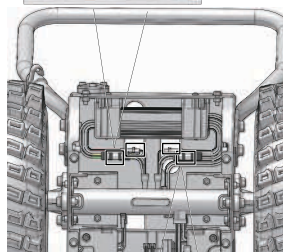
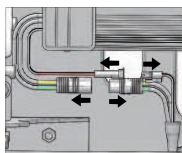

10.9 LED HEADLIGHTS

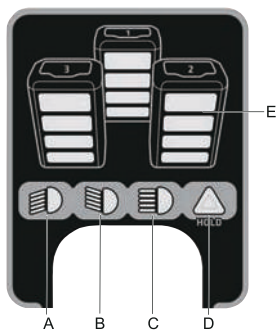
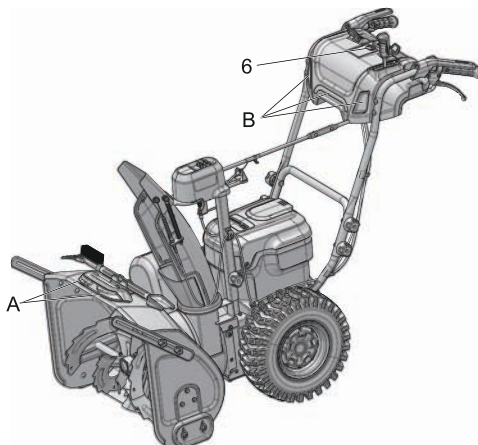

Turning the headlights on :

- Push the button (6) to turn on the LED light.

Turning the headlights off :

- Push the button (6) to turn off the LED light.

Push button to adjust the light:

- A. Turn on the front lights.
- B. Turn on the rear lights.
- C. Turn off all the lights.
- D. Warning.

10.10 ADJUST THE DISCHARGE CHUTE

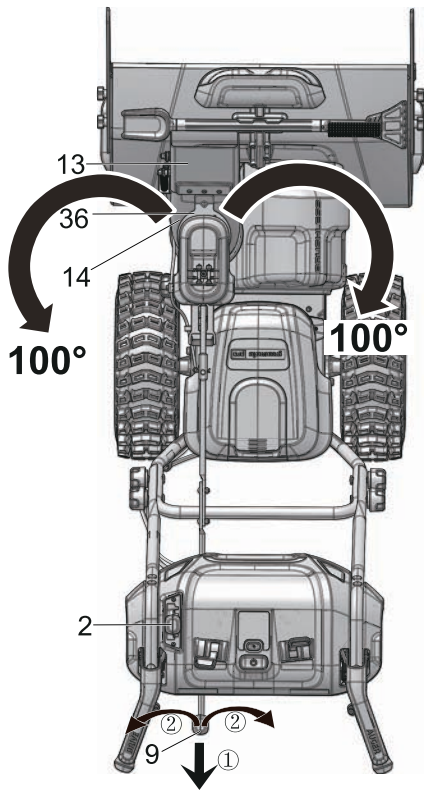

You can adjust the discharge chute 200° to change the snow direction.

1. Pull back the chute adjustment handle (9) for a short distance. (The lock button (37) will be pulled down to allow the chute move.)

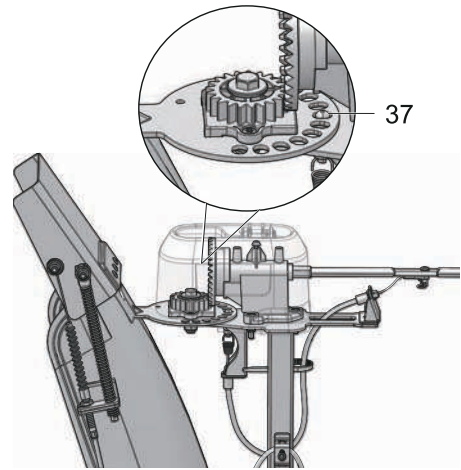
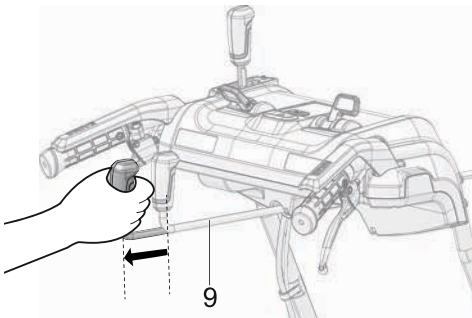

2. Rotate the chute adjustment handle (9) left to move the discharge chute (14) to the left. Release the grip handle to lock the chute in the disred direction.
3. Rotate the chute adjustment handle (9) right to move the discharge chute (14) to the right. Release the grip handle to lock the chute in the disred direction.

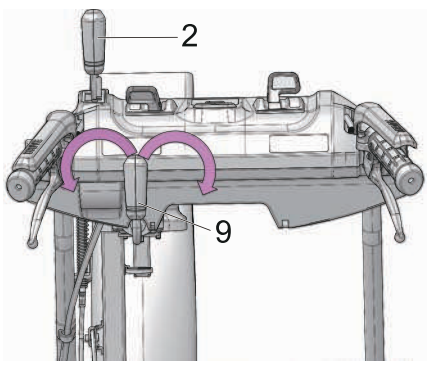

10.11 ADJUST THE CHUTE DEFLECTOR

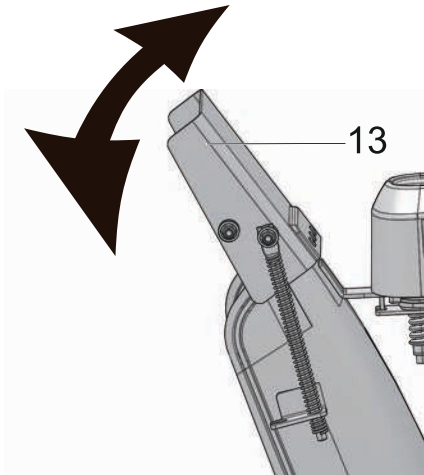

You can adjust the chute deflector up and down to change the throwing distance of the snow.

▲ WARNING

Turn off the machine before you adjust the chute deflector.

▲ WARNING

Do not push the trigger so far forward that a gap shows between the deflector and the chute.

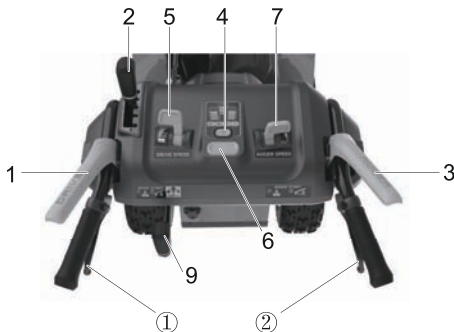

1. Grip and hold the chute deflector control lever (2).
2. Pull the chute deflector control lever (2) to the left and hold to unlock position.
3. Move the chute deflector control lever (2) forward to adjust the deflector (13) down and decrease the snow throw distance.

4. Move the chute deflector control lever (2) backward to adjust the deflector (13) up and increase the snow throw distance.

10.12 OPERATION TIPS

- If it is possible, clear the snow with the direction of the wind.
- In strong winds, lower the chute deflector to direct the snow to the ground.
- When you complete the work, let the machine operate for a while to prevent ice formation in the discharge chute.
- If the snow is deeper than 8", decrease the speed and let the machine work at its own rhythm.
- Do not use the scraper to remove compact snow and ice.

11 MAINTENANCE

▲ WARNING

Remove the safety key and battery pack from the machine before maintenance.

▲ CAUTION

Use only approved replacement parts.

▲ CAUTION

Do not let brake fluids, gasoline, petroleum-based materials touch the plastic parts. Chemicals can cause damage to the plastic, and make the plastic unserviceable.

▲ CAUTION

Do not use strong solvents or detergents on the plastic housing or components.

11.1 GENERAL MAINTENANCE

- Before each use, examine the machine for damaged, missing, or loose parts such as screws, nuts, bolts and caps.
- Tighten correctly all the fasteners and caps.
- Clean the remaining snow on the machine with a brush.

- Make sure that the machine does not have loose or damaged parts. If it is necessary, do these steps/ instructions:
 - Replace the damaged parts.
 - Tighten the bolts.
 - Speak to a person at an approved service center.
- Store the machine in a dry area.
- Make sure that children cannot come near the machine.

12 TROUBLESHOOTING

Problem	Possible cause	Solution
The handle is not in position.	The bolts are not engaged correctly.	Adjust the height of the handle and make sure that the knobs and bolts are aligned correctly.
The machine does not start.	The battery is not charged.	Charge the battery by following the procedures in the battery and charger manual.
	The switch is defective.	Have the switch replaced by an authorized service center.
	Battery is too cold.	Remove battery from snow thrower. Place battery on charger and allow to charge for 10 minutes or until the changing light turns green. Remove from charger and install in snow thrower for use.
	Battery may require service or replacement.	Call toll free helpline, at 1-855-345-3934 or replace battery.
The engine is on, but the impeller does not turn.	The belt is damaged.	Replace the belt.
A thin layer of snow stays behind.	The scraper is damaged.	Replace the scraper.

* If you cannot find the solution to these problems, call 1-855-345-3934.

13 TECHNICAL DATA

Voltage	60V
Clearing width	24 in.
Intake height	20 in.
Throwing distance	50 ft
Wheel size	15 in.
Weight (without battery pack)	80 kg (176.4 lbs)
Battery	60BA08 and other BAC series
Charger	60DPC10A and other CAC series

14 LIMITED WARRANTY



Greenworks hereby warrants this product, to the original purchaser with proof of purchase, for a period of four (4) years against defects in materials, parts or workmanship. Greenworks, at its own discretion will repair or replace any and all parts found to be defective, through normal use, free of charge to the customer. This warranty is valid only for units which have been used for personal use that have not been hired or rented for industrial/commercial use, and that have been maintained in accordance with the instructions in the owners' manual supplied with the product from new.

ITEMS NOT COVERED BY WARRANTY:

1. Any part that has become inoperative due to misuse, commercial use, abuse, neglect, accident, improper maintenance, or alteration; or
2. The unit, if it has not been operated and/or maintained in accordance with the owner's manual; or
3. Normal wear;
4. Routine maintenance items such as lubricants, blade sharpening;
5. Normal deterioration of the exterior finish due to use or exposure.

11.5 REPLACE THE SAFETY PIN

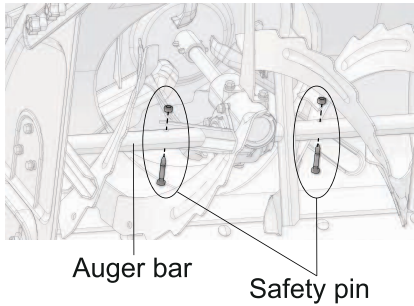

i NOTE

The safety pin is used to disperse the pressure of snow to protect the auger/impeller bar.

1. Remove the nuts and safety pins.
2. Install the new safety pins. (The spare safety pins are on the top of the chute support.)

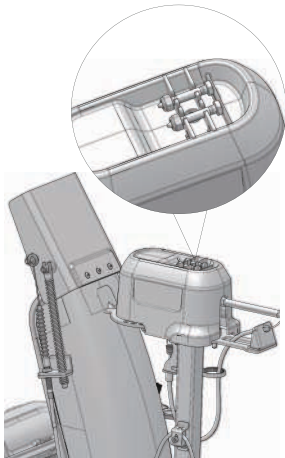

11.6 REPLACE THE DRIFT CUTTER

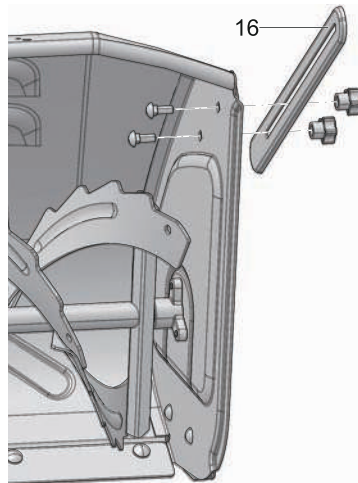

1. Remove the batteries.
2. Insert the two bolts into the intake housing wall.
3. Install the drift cutter and wing nuts onto the bolts.
4. Pre-tighten the wing nuts and keep the drift cutter a little loose for adjustment.
5. Move the drift cutter to the desired position and tighten the wing nuts.

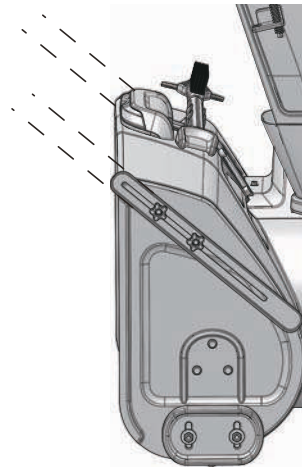

11.7 STORE THE MACHINE

- Clean the machine before storage.
- Make sure the motor is not hot when you store the machine.

11.2 CLEAR THE CLOGGED CHUTE

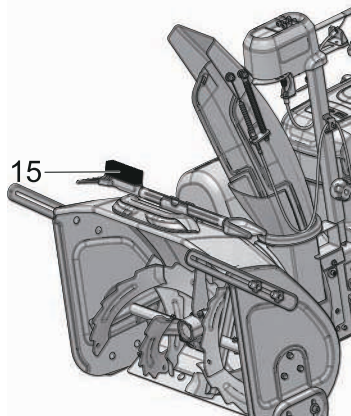

▲ WARNING

- **Never use your hand to clean out the chute.** Failure to follow these instructions can result in serious personal injury.
- Never reach into the discharge chute or place any body part in front of the snow thrower when the unit is operating or when the battery packs are installed.

To clear the discharge chute:

- Push the ON/OFF button to turn off the machine.
- Remove the battery packs.
- Wait 10 seconds to be sure the auger has stopped rotating.
- Always use the chute clean tool (15) which is attached to the machine as an accessory.

11.3 REPLACE THE SKID SHOES

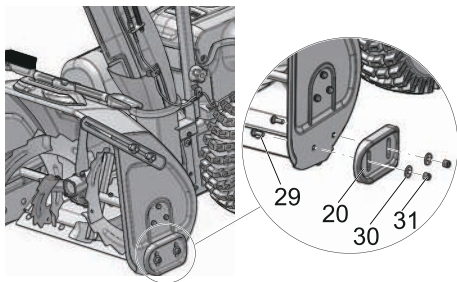

i NOTE

The range of adjustable height for skid shoes is 1.5mm, when putting the bolts through the U-hole on the skid shoes.

1. Loosen the 2 sets of bolts (29), spacers (30) and nuts (31) that attach the skid shoe (20) to the snow thrower housing.
2. Remove the skid shoe (20).
3. Install the new skid shoe (20).
4. Repeat the same operation on the other side.

11.4 REPLACE THE SCRAPER PLATE

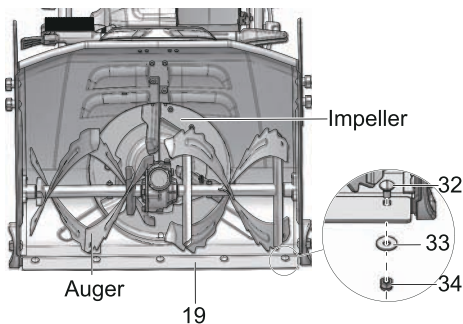

▲ WARNING

Use only approved replacement scraper plates.

▲ WARNING

Wear heavy gloves or wind cloth around the blade when you touch the blade.

1. Remove the nuts (34) and spacers (33) from scraper plate.
2. Remove the screws (32) and discard the old scraper plate.
3. Install the new scraper plate.
4. Reinstall the screws (32), spacer plates (33) and tighten them with the nuts (34)

HELPLINE:

Warranty service is available by calling our toll-free helpline, at 1-855-345-3934.

TRANSPORTATION CHARGES:

Transportation charges for the movement of any power equipment unit or attachment are the responsibility of the purchaser. It is the purchaser's responsibility to pay transportation charges for any part submitted for replacement under this warranty unless such return is requested in writing by Greenworks.

USA address:

Greenworks Tools

P.O. Box 1238

Mooresville, NC 28115

Canadian address:

Greenworks Tools Canada
Inc.

P.O. Box 93095, Newmarket,
Ontario

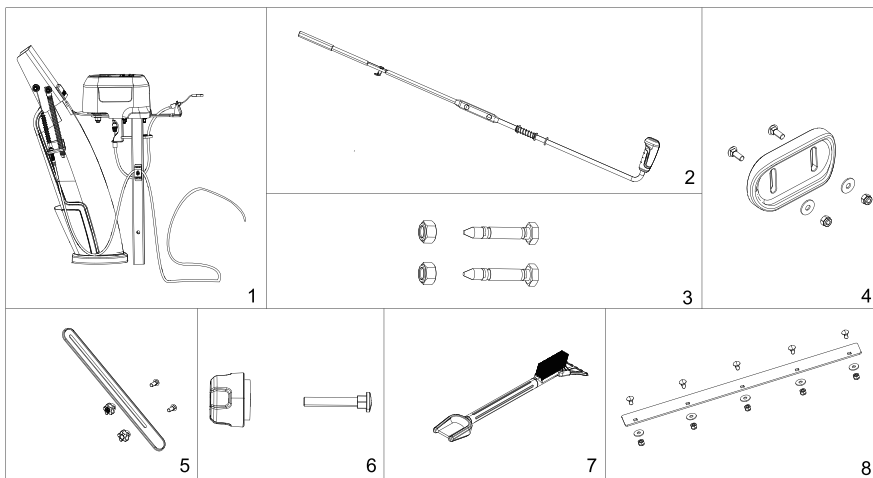
15 EXPLODED VIEW

No.	Part No.	Qty	Description
1	R0203398-00	1	Chute Deflector Assembly
2	R0203399-00	1	Control Rod Assembly
3	R0203424-00	2	Safety Pin Assembly
4	R0203400-00	1	Skid Plate Assembly
5	R0203401-00	1	Snow Breaker Assembly
6	R0203402-00	1	Knob and Bolt
7	R0203403-00	1	3-in-1 Brush Assembly
8	R0203404-00	1	Scraper Assembly