

# greenworks®

GPW3000

EN

PRESSURE WASHER

OPERATOR MANUAL

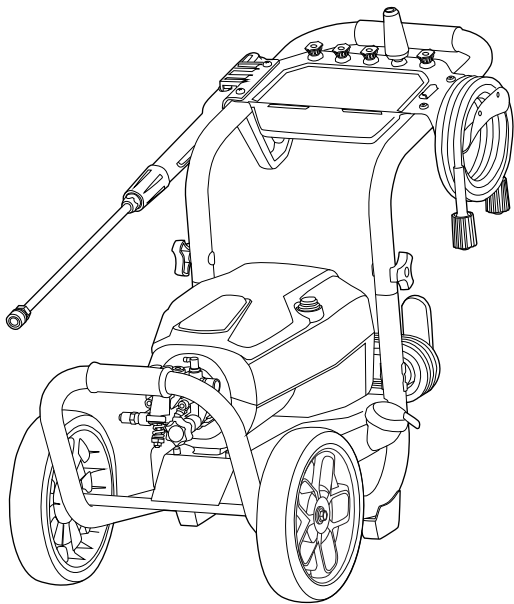

PWA207

[www.greenworkstools.com](http://www.greenworkstools.com)



<b>1</b>	<b>Description.....</b>	<b>4</b>	4.1	Connect the water supply to the machine.....	8
1.1	Intended use.....	4	4.2	Use the spray gun.....	9
1.2	Overview.....	4	4.3	Change the spray tip.....	9
<b>2</b>	<b>Safety.....</b>	<b>4</b>	4.4	Add detergent.....	10
2.1	Safety definitions.....	4	4.5	Start the machine.....	11
2.2	Inspect safety features.....	5	4.6	Stop the machine.....	11
2.3	Safety instructions for maintenance.....	5	4.7	Thermal relief valve function.....	11
2.4	Symbols on the product.....	6	<b>5</b>	<b>Maintenance.....</b>	<b>11</b>
2.5	Proposition 65.....	6	5.1	Spray tip maintenance.....	11
2.6	Risk levels.....	6	<b>6</b>	<b>Transportation and storage.....</b>	<b>12</b>
<b>3</b>	<b>Installation.....</b>	<b>7</b>	6.1	Move the machine.....	12
3.1	Electrical connection.....	7	6.2	Store the machine.....	12
3.2	Unpack the machine.....	7	<b>7</b>	<b>Troubleshooting.....</b>	<b>13</b>
3.3	Install the upper panel.....	7	<b>8</b>	<b>Technical data.....</b>	<b>14</b>
3.4	Install the spray gun holder.....	7	<b>9</b>	<b>Limited warranty.....</b>	<b>14</b>
3.5	Install the power cord storage arms.....	8	9.1	Items not covered by warranty.....	14
3.6	Install the upper handle.....	8	9.2	Helpline.....	14
3.7	Install the spray wand.....	8	9.3	Shipping.....	14
3.8	Install the high-pressure hose.....	8			
<b>4</b>	<b>Operation.....</b>	<b>8</b>			

## 1 DESCRIPTION

### 1.1 INTENDED USE

The product is used to clean vehicles, boats, buildings, porches, decks, patios and driveways.

For residential use only, not for professional use and for operation at temperature above 32°F (0°C).

### 1.2 OVERVIEW

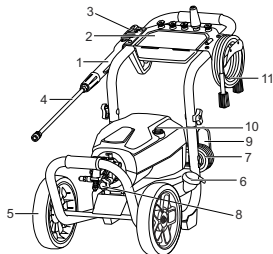

1 Spray Gun	7 Power cord
2 Upper panel	8 Water inlet
3 Spray gun holder	9 Cord storage arm
4 Spray wand	10 Power switch
5 Wheel	11 High pressure hose
6 Detergent tank	

## 2 SAFETY

### 2.1 SAFETY DEFINITIONS

Warnings, cautions, and notes are used to point out especially important parts of the manual.

#### ⚠ WARNING

**THERE IS A RISK OF INJURY OR DEATH FOR THE OPERATOR OR BYSTANDERS, IF THE INSTRUCTIONS IN THE MANUAL ARE NOT OBEYED.**

#### ⚠ CAUTION

**THERE IS A RISK OF DAMAGE TO THE PRODUCT, OTHER MATERIALS, OR THE ADJACENT AREA, IF THE INSTRUCTIONS IN THE MANUAL ARE NOT OBEYED.**

**Note:** Used to give more information that is necessary in a given situation.

### 2.1.1 IMPORTANT SAFETY INSTRUCTIONS

#### ⚠ WARNING

When using this product basic precautions should always be followed, including the following:

1. Read all the instructions before using the product.
2. To reduce the risk of injury, close supervision is necessary when a product is used near children.
3. Know how to stop the product and bleed pressures quickly. Be thoroughly familiar with the controls.
4. Stay alert – watch what you are doing.
5. Do not operate the product when fatigued or under the influence of alcohol or drugs.
6. Keep operating area clear of all persons.
7. Do not overreach or stand on unstable support. Keep good footing and balance at all times.
8. Follow the maintenance instructions specified in the manual.
9. **WARNING – Risk of Injection or Injury– Do Not Direct Discharge Stream At Persons.**

### 2.1.2 GROUNDING FAULT CIRCUIT INTERRUPTER PROTECTION

- The product is equipped with a ground fault circuit interrupter (GFCI) built into the power cord plug.
- The GFCI provides additional protection from the risk of electric shock.
- If you need to replace the plug or cord, ensure that you only use identical replacement parts that include GFCI protection.

### 2.1.3 SERVICING OF A DOUBLE INSULATED APPLIANCE

- In a double-insulated product, two systems of insulation are provided instead of grounding.
- A double-insulated product does not have a grounding mechanism included, nor should any means for grounding be added to the product.
- Servicing a double-insulated product requires extreme care and knowledge of the system, and should be done only by qualified service personnel.
- Replacement parts for a double-insulated product must be identical to the parts they replace.
- A double-insulated product is marked with the words "DOUBLE-INSULATION" or "DOUBLE-INSULATED." The symbol is



### 2.1.4 EXTENSION CORD(S)

- Use only extension cord(s) that are intended for outdoor use.
- These extension cord(s) are identified by a marking "Acceptable for use with outdoor appliances; store indoors while not in use."
- Use only extension cord(s) marked with an electrical rating not less than the rating of the product.
- Do not use damaged extension cord(s).
- Examine extension cord(s) before using and replace if damaged.
- Do not abuse extension cord(s) and do not yank on any cord(s) to disconnect.
- Keep cord(s) away from heat and sharp edges.
- Always disconnect the extension cord(s) from the power strip before disconnecting the product from the extension cord(s).
- **WARNING** – To reduce the risk of electrocution, keep all connections dry and raised above the ground.
- Do not touch electric plug with wet hands.

## 2.2 INSPECT SAFETY FEATURES

### 2.2.1 CHECK THE SPRAY GUN

- If the spray gun trigger depresses without pressing safety lock or if the spray gun remains depressed when released, replace the spray gun immediately.

### 2.2.2 CHECK THE HIGH-PRESSURE HOSE

- If the high-pressure hose is damaged, replace immediately.

### 2.2.3 CHECK THE WATER INLET SCREEN

Inspect the inlet screen. Remove debris or replace if damaged.

## 2.3 SAFETY INSTRUCTIONS FOR MAINTENANCE



### WARNING











Read the warning instructions that follow before you do maintenance on the product.

- Before inspecting, cleaning, or servicing the product, shut off the product, wait for all moving parts to stop, disconnect the product from the power supply, and squeeze the spray gun trigger to release water pressure. Failure to follow these instructions can result in serious personal injury or property damage.
- When servicing, use only identical replacement parts. Use of any other parts could create a hazard or cause product damage.

- Periodically inspect the entire product for damaged, missing, or loose parts such as screws, nuts, bolts, caps, etc. Securely tighten all fasteners and caps and do not operate this product until all missing or damaged parts are replaced. Please call customer service or contact an authorized service center for assistance.
- Avoid using solvents when cleaning plastic parts. Most plastics are susceptible to damage from various types of commercial solvents and may be damaged by their use. Use clean cloths to remove dirt, dust, oil, grease, etc.
- Do not at any time let brake fluids, gasoline, petroleum-based products, penetrating oils, etc., come in contact with plastic parts. Chemicals can damage, weaken, or destroy plastic which could result in serious personal injury.
- Neglecting regular maintenance decreases the life cycle of the product and increases the risk of accidents.
- Special training is necessary for all servicing and repair work, especially for the safety features on the product. If not all checks in this operator's manual are approved after maintenance, speak to your servicing dealer. We guarantee that there are professional repairs and servicing available for your product.

### SAVE THESE INSTRUCTIONS

## 2.4 SYMBOLS ON THE PRODUCT

Symbol	Explanation
	Carefully read and understand instructions before operating the product and follow all warnings and safety instructions.
	Do not expose the product to rain or moist conditions.
	Always wear safety goggles or safety glasses with side shields and, as necessary, a full-face shield when operating this product.
	To reduce the risk of high-pressure injection or injury, never direct a water stream towards people or pets or place any body part in the stream. Leaking hoses and fittings can also cause injury. Do not place hands near high-pressure stream.
	To reduce the risk of injury from kickback, hold the spray gun securely with both hands when the product is on.
	Failure to operate in dry conditions and neglecting safe practices can increase risk of electric shock.
	Burst hazard.
	Warning! Never aim the spray gun at humans, animals, the product, power supply, or any electrical appliances.
	The product is not suitable for connection to the drinking water mains without backflow preventer.
	Only set product on flat, horizontal surfaces. Never lift product during operation.
	Keep hands and feet away from the cleaning area while the product is running.



## 2.5 PROPOSITION 65

 WARNING
<p>This product contains a chemical known to the state of California to cause cancer, birth defects or other reproductive harm. Some dust created by power sanding, sawing, grinding, drilling, and other construction activities contains chemicals known to cause cancer, birth defects or other reproductive harm. Some examples of these chemicals are:</p> <ul style="list-style-type: none"> <li>• Lead from lead-based paints;</li> <li>• Crystalline silica from bricks and cement and other masonry products;</li> <li>• Arsenic and chromium from chemically treated lumber.</li> </ul> <p>Your risk of exposure to these chemicals varies depending on how often you do this type of work. To reduce your exposure to these chemicals, work in a well-ventilated area, and work with approved safety equipment, such as dust masks that are specially designed to filter out microscopic particles.</p>

## Save these instructions.

## 2.6 RISK LEVELS

The following signal words and meanings are intended to explain the levels of risk associated with this product.

SYMBOL	SIGNAL	MEANING
	DANGER	Indicates an imminently hazardous situation, which, if not avoided, will result in death or serious injury.
	WARNING	Indicates a potentially hazardous situation, which, if not avoided, could result in death or serious injury.
	CAUTION	Indicates a potentially hazardous situation, which, if not avoided, may result in minor or moderate injury.
	CAUTION	(Without Safety Alert Symbol) Indicates a situation that may result in property damage.

### 3 INSTALLATION

#### 3.1 ELECTRICAL CONNECTION

This machine has a precisely built electrical motor. It should be connected to a power supply that is 120V, 60 Hz, AC only (household). Do not operate this machine on direct current (DC). A considerable voltage drop will cause a loss of power and the motor will be overheated.

##### 3.1.1 PREPARE A DRIP LOOP

Recommend the use of a drip loop as below so the water cannot run along the power cord even possibly reach the electrical outlet and plug.

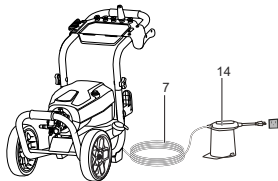

#### ⚠ WARNING

Keep the extension cord clear of the working area. Position the cord so that it will not get caught on lumber, tools, or other obstructions while you are working with a power tool. Failure to do so can result in serious personal injury.

#### 3.2 UNPACK THE MACHINE

#### ⚠ WARNING

Make sure that you correctly assemble the machine before use.

#### ⚠ WARNING

- If the parts are damaged, do not use the machine.
- If you do not have all the parts, do not operate the machine.
- If the parts are damaged or missing, speak to the service center.

1. Open the package.
2. Read the documentation in the box.
3. Remove all the unassembled parts from the box.
4. Remove the machine from the box.
5. Discard the box and package in compliance with local regulations.

#### 3.3 INSTALL THE UPPER PANEL

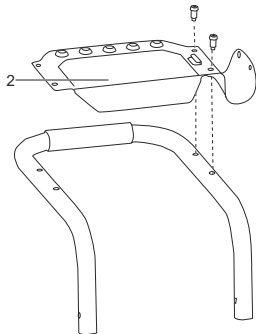

1. Align the screw sleeves of the front panel (2) with the screw holes on the upper handle.
2. Tighten them with a Phillips screwdriver (not included).

#### 3.4 INSTALL THE SPRAY GUN HOLDER

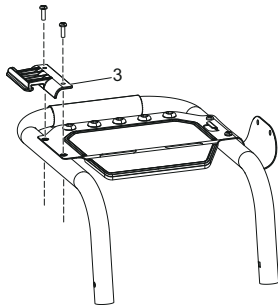

1. Align the screw sleeves of the spray gun holder (3) with the screw holes on the upper handle.
2. Tighten them with a Phillips screwdriver (not included).

### 3.5 INSTALL THE POWER CORD STORAGE ARMS

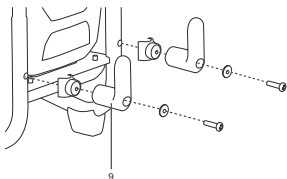

1. Attach each of the power cord storage arms (9) into the two separate positions on the lower handle of the fixture.
2. Align the screw (13) with the holes in each of the two power cord storage arms (9).
3. Push the screw (13) through and tighten both power cord storage arms (9) with a Phillips head screwdriver (not included).

### 3.6 INSTALL THE UPPER HANDLE

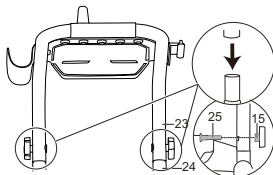

1. Align the holes on the upper handle (23) and the lower handle (24).
2. Insert the handle bolts (25) and use the handle knobs (15) to tighten them.

### 3.7 INSTALL THE SPRAY WAND

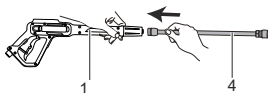

1. Push the end of the spray wand (4) into the trigger handle (1) and rotate clockwise to secure.
2. Pull on the spray wand (4) to be certain it is properly secured.

#### ⚠ WARNING

Make sure that the connection has no leakage.

### 3.8 INSTALL THE HIGH-PRESSURE HOSE

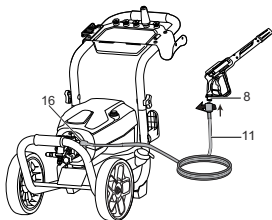

1. Push and turn clockwise one end of the high-pressure hose (11) into the inlet coupler (8).
2. Install and tighten the other end of the high-pressure hose onto the water outlet (16) coupler.

### 4 OPERATION

#### ⚠ WARNING

Make sure that all the connections are tight and have no leakage before operation.

#### 4.1 CONNECT THE WATER SUPPLY TO THE MACHINE

For easy operation, please use a self-coiling garden hose (not provided).

#### ⚠ WARNING

When you operate the self-coiling hose, make sure that the hose has no blockage.

#### ⚠ WARNING

- The water supply must come from the water main
- Do not use hot water
- Do not use water from ponds or lakes

#### ⚠ WARNING

Always observe all the local regulations when you connect the garden hose to the water supply. Direct connection through a receiver tank or backflow preventer is usually permitted.



**CAUTION**

Inspect the filter in the water inlet connector before you connect the garden hose

- If the filter is damaged, do not use the machine until the filter is replaced.
- If the filter is dirty, clean the filter.

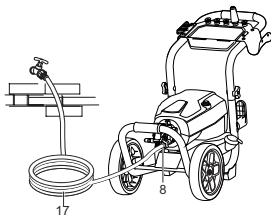

1. Uncoil the garden hose (17).
2. Let the water flow through the garden hose (17) for 30 seconds.
3. Turn the water supply off.
4. Install and tighten the end of the garden hose (17) to the water inlet (8) connector.

**CAUTION**

There must be a minimum of 10 feet of free hose between the water inlet and the water supply.

#### 4.2 USE THE SPRAY GUN

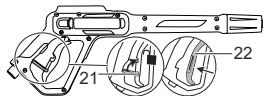

**WARNING**

For safe control, keep your hands on the spray gun at all times.

- Pull and hold the spray gun trigger (21) to start the machine.
- Release the spray gun trigger (21) to stop water flow through the spray tip.

#### 4.2.1 UNLOCK THE SPRAY GUN TRIGGER

- Push the trigger safety lock-out (21) down until it clicks into the slot.

#### 4.2.2 LOCK THE SPRAY GUN TRIGGER

- Push the trigger safety lock-out (21) up and into its original position.

#### 4.3 CHANGE THE SPRAY TIP

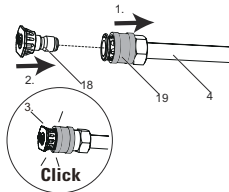

**WARNING**





Before you change the spray tip:

1. Pull the spray gun trigger to release water pressure.
2. Engage the trigger safety lock-out on the spray gun.
3. Stop the machine.

**WARNING**

Do not point the spray wand at your face or others'.

## 4.3.1 NOZZLE OR SPRAY TIP TYPE

SPRAY TIP	APPLICATION
 15°	<b>Yellow - Narrow fan tip (15°)</b> <ul style="list-style-type: none"> <li>Provide maximum pressure for hard surface preparation, such as removing dirt, mildew, and paint. Not recommended on fragile surfaces.</li> </ul>
 25°	<b>Green - Narrow fan tip (25°)</b> <ul style="list-style-type: none"> <li>Versatile washing tip that effectively removes dirt without damaging most surfaces. Ideal for fences and broad cleaning areas.</li> </ul>
 40°	<b>White - Wide fan tip (40°)</b> <ul style="list-style-type: none"> <li>Deliver wide cleaning coverage at lower pressure. Suitable for delicate cleaning tasks, like car surfaces.</li> </ul>
 SOAP	<b>Black - Soap spray tip</b> <ul style="list-style-type: none"> <li>The black soap spray tip, is used for soap application. Soap is applied under low-pressure high volume for optimum performance. Soap cannot be applied under high-pressure with this machine.</li> </ul>
	<b>Turbo nozzle tip</b> <ul style="list-style-type: none"> <li>The nozzle rotates in a zero-to-15-degree spray pattern in a circular motion to break down tough dirt and grime. The spray pattern can cover area of 4 to 8 inches wide, depending on a distance between the tip and the surface being cleaned.</li> </ul>

## 4.3.2 INSTALL THE SPRAY TIP

- Pull back the quick-connect collar (19) on the spray wand (4).
- Insert the spray tip (18) onto the spray wand (4).
- Release the quick-connect collar (19) to attach the spray tip (18).
- Pull on spray tip (18) to ensure it is properly installed and does not pull out.

## 4.4 ADD DETERGENT

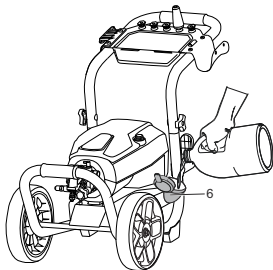
**⚠ WARNING**

Do not use household detergents, acids, alkalines, bleaches, solvents, flammable material, or industrial grade solutions, which can do damage to the pump.

**⚠ WARNING**

Read the instructions on the solution bottle to prepare detergent.

**i NOTE**

If it is necessary, use a funnel to prevent the spill of detergent. Clean and dry the spilled detergent when you fill the tank.

**i NOTE**

Soap/detergent can only be applied with this machine when the black nozzle(75 degree) is installed.

- Place the pressure washer upright on a flat surface.
- Open the cap on the detergent tank (6).
- Pour detergent into tank (6).
- Reinstall cap.

**i NOTE**

Do not let detergent dry on the surface to prevent streaks.

#### 4.5 START THE MACHINE

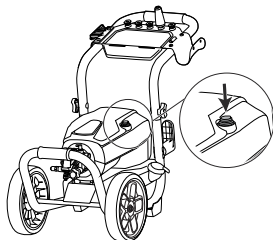

#### CAUTION

Do not operate without the water supply connected.

#### CAUTION

Before you start the machine:

1. Turn the water supply on.
  2. Pull the gun trigger to release air pressure.
  3. If a stable stream of water come into view, release the spray gun trigger.
1. Turn the water supply on.
  2. Connect the machine to the power supply.
  3. Press down on the ON/OFF switch once to set the power switch to the "ON" (I) position.
  4. Pull the spray gun trigger.

#### 4.6 STOP THE MACHINE

1. Release the spray gun trigger.
2. Press down on the ON/OFF switch, once again, to set the power switch to the "OFF" (O) position.

#### WARNING

If you do not use the machine :

- Stop the machine.
- Turn the water supply off.
- Disconnect the power cord from the outlet.
- Pull the spray gun trigger to release the remaining pressure from the machine.
- Engage the trigger safety lock-out on the spray gun.

#### 4.7 THERMAL RELIEF VALVE FUNCTION

The thermal relief valve is a thermal protector for the pressure washer pump. This pump feature will

prevent water temperatures from reaching harmful levels by releasing a small amount of water. Opening temperature is 140°F. The valve will reset automatically once the pump relieves.

#### 5 MAINTENANCE

#### WARNING

Before maintenance, make sure that you

- Stop the machine.
- Wait until all the moving parts stop.
- Disconnect the plug from the power source.

#### WARNING

Do not use strong solvents or detergents on the plastic housing or components.

#### WARNING

Do not let brake fluids, gasoline, petroleum-based materials touch the plastic parts. Chemicals can cause damage to the plastic, and make the plastic unserviceable.

#### WARNING

Replace the power cord by an approved service center.

#### 5.1 SPRAY TIP MAINTENANCE

#### WARNING

Never point the spray wand at your face.

#### 5.1.1 REMOVE THE SPRAY TIP

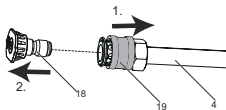

1. Pull back the quick-connect collar (19) on the spray wand (4).
2. Remove the spray tip (18) from the spray wand (4).

### 5.1.2 CLEAN THE SPRAY TIP

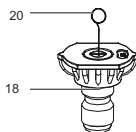

1. Use a straight paper clip or cleaning tool (20) to clean the spray tip.
2. Flush and clean the unwanted materials out of the spray tip (18) with the garden hose (17).
3. Install the clean spray tip (18) back into the spray wand (4). [See 4.3.2]

## 6 TRANSPORTATION AND STORAGE

### ⚠ WARNING

Disconnect the power cord and water supply hose before transportation and storage.

### 6.1 MOVE THE MACHINE

- Point the spray wand in a safe direction.
- Only hold the machine with the handgrip.

### 6.2 STORE THE MACHINE

### ⚠ WARNING

Make sure that the spray gun, the high-pressure hose and the machine are dry.

### ⚠ WARNING

Make sure the machine is out of the reach of children.

- Disconnect the garden hose from machine.
- Wind the power cord and the high-pressure hose.
- Clean housing and the plastic components with a moist and soft cloth.
- Make sure that the machine does not have loose or damaged parts. If it is necessary, follow these steps/ instructions:
  - Replace the damaged parts.
  - Tighten the bolts.
  - If needed, call the customer service phone number for servicing instructions.
- Store the machine in a dry, isolated and frost-free area.

## 7 TROUBLESHOOTING

PROBLEM	POSSIBLE CAUSE	SOLUTION
The motor does not start.	The power button is in the "OFF" (O) position.	Set the power switch to the "ON" (I) position.
	The power cord is not plugged in.	Connect the power cord to the power supply.
	Electrical outlet does not supply sufficient power.	Try another electrical outlet.
	The circuit breaker is tripped.	Let it cool, and start the machine again.
	The power switch is on, but you do not pull the spray gun trigger.	Pull the spray gun trigger.
The machine does not reach high pressure.	The diameter of garden hose is too small.	Replace with a 1" (25 mm) or 5/8" (16 mm) garden hose.
	Water supply is restricted.	Check garden hose for kinks, leaks, and blockage.
	The water supply is not sufficient.	Turn on the water supply fully.
	Spray tip has not been installed onto the spray wand properly.	Install desired spray tip to end of wand.
	The water intake filter is clogged.	Remove filter and rinse in warm water.
The output pressure varies high and low.	The water supply is not sufficient.	Turn on the water supply fully. Check garden hose for kinks, leaks, or blockage.
	The pump is drawing in air.	<ol style="list-style-type: none"> <li>1. Make sure that the hoses and fitting are airtight.</li> <li>2. Turn "OFF" machine.</li> <li>3. Purge pump by squeezing trigger gun until a steady flow of water comes out the spray tip.</li> </ol>
	The water intake filter is clogged.	Remove the filter and rinse in warm water.
	The supply voltage is low.	Make sure that only the pressure washer is running on the circuit.
	The gun, hose or nozzle are calcified.	Run distilled vinegar through detergent tank.
The motor buzzes, but the machine does not start.	The supply voltage is low.	Make sure that only the pressure washer is running on the circuit.
	The pump system has residual pressure.	<ol style="list-style-type: none"> <li>1. Turn "OFF" the machine.</li> <li>2. Pull the spray gun trigger on spray wand to release pressure.</li> <li>3. Turn the machine "ON".</li> </ol>

PROBLEM	POSSIBLE CAUSE	SOLUTION
	Voltage loss due to use of an improper extension cord.	Disconnect the extension cord, and connect the machine directly into the outlet.
	Pressure washer not used for long periods.	Call customer service.
	Residual friction among components. Machine might emit a humming noise.	<ol style="list-style-type: none"> <li>1. Disconnect the water supply.</li> <li>2. Power "ON" the machine for 2 to 3 seconds.</li> <li>3. Repeat the above step a couple of times or until the motor starts.</li> </ol>
There is no water.	The water supply is off.	Turn the water supply on.
	The garden hose is kinked.	Remove kink in garden hose.

## 8 TECHNICAL DATA

Voltage	120V~ 60 Hz, 14 Amps
Max. Pounds Per Square Inch Pressure	3000 PSI
Rated Gallons Per Minute	1.1 GPM
Maximum Inlet Water Temperature	104 °F (40 °C)
Cleaning Units	3300 C.U.
	Double-insulated construction.

## 9 LIMITED WARRANTY

### 90-Day Warranty

Renewed/Refurbished products and batteries are protected against all defects in materials, parts or workmanship under normal use for a period of 90 days from the shipping date or in-store purchase date. All sales are final, no returns.

## 9.1 ITEMS NOT COVERED BY WARRANTY

- Any part that has become inoperative due to misuse, commercial use, abuse, neglect, accident, improper maintenance, or alteration.
- The unit, if it has not been operated and/or maintained in accordance with the operator manual.
- Normal wear, except as noted below:
  - Routine maintenance items such as lubricants.
  - Normal deterioration of the exterior finish due to use or exposure.
- Any part/product, that has become inoperative due to use with any non-**Greenworks**-branded parts or batteries/chargers.

## 9.2 HELPLINE

Warranty service is available by calling our toll-free helpline at: 1-855-345-3934.

## 9.3 SHIPPING

Transportation charges for the movement of any power equipment unit or attachment are the responsibility of the purchaser. It is the purchaser's responsibility to pay transportation charges for any part submitted for replacement under this warranty unless such return is requested in writing by **Greenworks**.

### 9.3.1 ADDRESS

**USA address:**

**Greenworks** Tools

P.O. Box 1238, Mooresville, NC 28115

**Canada address:**

**Greenworks** Tools Canada, Inc.

P.O. Box 93095, Newmarket, Ontario, L3Y 8K3

**Mexico address:**

TECNOLOGIA CAMPO Y JARDIN S.A. DE C.V.

ADMINISTRADORES No. 5336 A, COL. ARCOS DE  
GUADALUPE, ZAPOPAN , JALISCO , C.P. 45037

# greenworks®

[www.greenworkstools.com](http://www.greenworkstools.com)



P0802862-05