

greenworks[®]

GPW1901SC

EN

PRESSURE WASHER

OPERATOR MANUAL

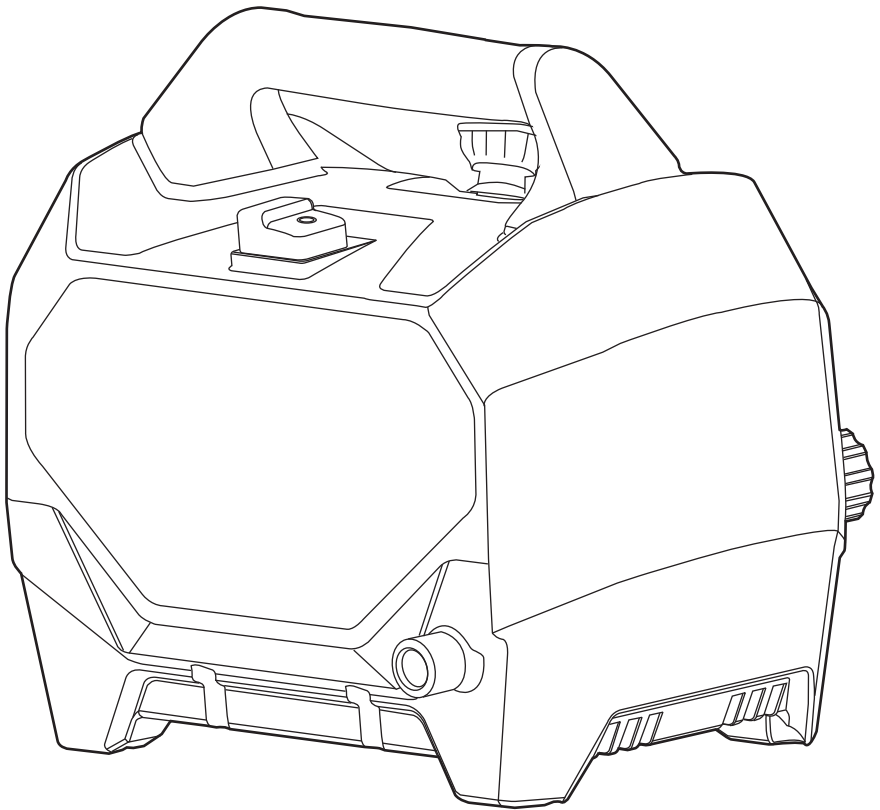

PWA108

www.greenworkstools.com

1	Description.....	4	12.2	Install the high pressure hose.....	7
1.1	Purpose.....	4	12.3	Connect the water supply to the product.....	7
1.2	Overview.....	4	12.4	Install the spray wand.....	8
2	Important safety instructions.....	4	12.5	Spray tips and nozzle.....	8
3	Electrical safety warnings.....	4	13	Operation.....	8
4	Pressure washer safety warnings.....	5	13.1	Prepare a drip loop.....	8
5	Ground fault circuit interrupter protection.....	5	13.2	Start the product.....	9
6	Servicing of a double insulated appliance.....	5	13.3	Stop the product.....	9
7	Extension cords.....	5	13.4	Install the soap applicator.....	10
8	Child safety.....	6	14	Maintenance.....	10
9	Proposition 65.....	6	14.1	Protect the pump.....	10
10	Symbols on the product.....	6	14.2	Spray tip maintenance.....	11
11	Risk levels.....	6	15	Transportation and storage.....	11
12	Installation.....	7	15.1	Move the product.....	11
12.1	Unpack the product.....	7	15.2	Store the product.....	11
			16	Troubleshooting.....	12
			17	Technical data.....	13
			18	Limited warranty.....	13

1 DESCRIPTION

1.1 PURPOSE

The product is used to clean vehicles, boats, buildings, porches, decks, patios and driveways.

For residential use only, not for professional use and for operation at temperature above 32°F (0°C).

1.2 OVERVIEW

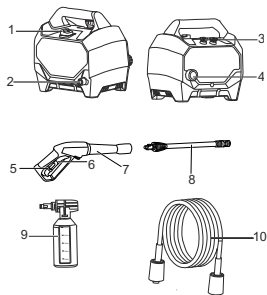

- | | | | |
|---|----------------------|----|--------------------|
| 1 | Power switch | 7 | Spray gun |
| 2 | Water outlet | 8 | Spray wand |
| 3 | Spray tip | 9 | Soap applicator |
| 4 | Water inlet | 10 | High pressure hose |
| 5 | Trigger safety latch | | |
| 6 | Spray gun trigger | | |

2 IMPORTANT SAFETY INSTRUCTIONS

IMPORTANT SAFETY INSTRUCTIONS WARNING –
When using this product basic precautions should always be followed, including the following:

- The machine is not intended for use by persons (including children) with reduced physical, sensory or mental capabilities, or lack of experience and knowledge, unless they have been given supervision or instruction concerning use of the machine by a person responsible for their safety. Children should be supervised to ensure that they do not play with the machine.
- Learn the machine's applications and limitations as well as the specified potential hazards related to this tool by studying this manual.
- Never operate the machine with any guard or cover removed or damaged.

- Do not operate the product while under the influence of drugs, alcohol, or any medication.
- Do not wear loose clothing, gloves, neckties, or jewelry. They can get caught and draw you into moving parts.
- Rubber gloves and non-skid footwear are recommended when working outdoors. Also wear protective hair covering to contain long hair. Wear footwear that will protect your feet and improve your grip on slippery surfaces.
- Do not overreach or stand on unstable support. Keep proper footing and balance at all times.
- Check the work area before each use. Remove all objects such as rocks, broken glass, nails, wire, or string which can be thrown or become entangled in the machine.
- Avoid dangerous environments. Do not expose to rain. Keep work area well lit.
- Before starting any cleaning operation, close doors and windows. Clear the area to be cleaned of debris, toys, outdoor furniture, or other objects that could create a hazard.
- Do not use the appliance within range of persons unless they wear protective clothing.

3 ELECTRICAL SAFETY WARNINGS

- Ground Fault Circuit Interrupter (GFCI) protection should be provided on the circuit(s) or outlet(s) to be used for the product.
- Disconnect from the electrical power supply before carrying out user maintenance.
- Use only extension cords that have watertight connections and are intended for outdoor use. Use only extension cords having an electrical rating not less than the rating of the product. Examine extension cord before using and replace if damaged. Do not abuse extension cord and do not pull on any cord to disconnect. Keep cord away from heat and sharp edges. Always disconnect the extension cord from the receptacle before disconnecting the product from the extension cord.
- Do not use the appliance if a supply cord or important parts of the appliance are damaged, e.g. safety devices, high-pressure hoses, trigger gun.
- Inadequate extension cords can be dangerous.
- To reduce the risk of electrocution, keep all connections dry and off the ground. Do not touch plug with wet hands.
- Do not abuse the cord. Never use the cord to carry the product or to disconnect the plug from an outlet. Keep cord away from heat, oil, sharp edges, or moving parts. Replace damaged cords immediately. Damaged cords increase the risk of electric shock.
- Inspect extension cords periodically and replace if damaged. Keep handles dry, clean, and free from oil or grease.

- If the supply cord is damaged, it must be replaced by the manufacturer or its service agent or a similarity qualified person in order to avoid a hazard.
- The electric supply should include a residual current device for max. 30 mA

4 PRESSURE WASHER SAFETY WARNINGS

- Read all the instructions before using the product.
- To reduce the risk of injury, close supervision is necessary when a product is used near children.
- Know how to stop the product and bleed unit pressure quickly. Be thoroughly familiar with the controls.
- Stay alert – watch what you are doing.
- Do not operate the product when fatigued or under the influence of alcohol or drugs.
- Keep operating area clear of all persons.
- Do not overreach or stand on unstable support. Keep good footing and balance at all times.
- Follow the maintenance instructions specified in the manual.
- This product is provided with a ground fault circuit interrupter built into the power cord plug. If replacement of the plug or cord is needed, use only identical replacement parts.
- Risk of injection or injury– Do not direct discharge stream at persons.
- Keep the motor away from flammables and other hazardous materials.
- Keep product dry, clean, and free from oil and grease. Always use a clean cloth when cleaning. Never use brake fluids, gasoline, petroleum-based products, or any solvents to clean product.
- High pressure jets can be dangerous if subject to misuse. The jet must not be directed at persons, live electrical equipment or the appliance itself do not direct the jet against yourself or others in order to clean clothes or footwear.
- High pressure washer shall not be used by children or untrained personnel.
- High pressure hoses, fittings and couplings are important for the safety of the appliance. Use only hoses, fittings and couplings recommended by the manufacturer.
- Use cleaning agent supplied or recommend by the manufacturer.
- Use only original spare parts from the manufacturer or approved by the manufacturer.

WARNING

To reduce the risk of electrocution, keep all connections dry and off the ground. Do not touch plug with wet hands.

5 GROUND FAULT CIRCUIT INTERRUPTER PROTECTION

- This pressure washer is provided with a ground-fault circuit-interrupter (GFCI) built into the plug of the power-supply cord.
- This device provides additional protection from the risk of electric shock.
- Should replacement of the plug or cord become necessary, use only identical replacement parts that include GFCI protection.
- This product must be grounded. If it should malfunction or breakdown, grounding provides a path of least resistance for electric current to reduce the risk of electric shock.
- This product is equipped with a cord having an equipment-grounding conductor and a grounding plug. The plug must be plugged into an appropriate outlet that is properly installed and grounded in accordance with all local codes and ordinances.
- DANGER – Improper connection of the equipment-grounding conductor can result in a risk of electrocution.
- Check with a qualified electrician or service personnel if you are in doubt as to whether the outlet is properly grounded.
- Do not modify the plug provided with the product – if it will not fit the outlet, have a proper outlet installed by a qualified electrician.
- Do not use any type of adaptor with this product.

6 SERVICING OF A DOUBLE INSULATED APPLIANCE

- Within a double insulated product, two systems of insulation are provided instead of grounding. No grounding means is provided on a double insulated product, nor should a means for grounding be added to the product. Servicing a double insulated product requires extreme care and knowledge of the system, and should be done only by qualified service personnel. Replacement parts for a double insulated product must be identical to the parts they replace. A double insulated product is marked with the words "DOUBLE INSULATION" or "DOUBLE INSULATED."

7 EXTENSION CORDS

- Use only extension cords that are intended for outdoor use. These extension cords are identified by a marking "Acceptable for use with outdoor appliances; store indoors while not in use." Use only extension cords having an electrical rating not less than the rating of the product. Do not use damaged extension cords. Examine extension cord before using and replace if damaged. Do not abuse extension cord and do not yank on any cord to disconnect. Keep cord away from heat and sharp edges. Always disconnect the extension cord from

the receptacle before disconnecting the product from the extension cord.

8 CHILD SAFETY

It is crucial to be aware of the presence of children to prevent injury.

- Keep children away from the working area and under the supervision of an adult.
- Stay alert and immediately release the trigger of the product if a child or any other person enters the working area.
- Use extreme caution when approaching blind corners, doorways, shrubs, trees, or other objects that may obscure your view of a child who could potentially run into the path of the product.
- Children should be supervised at all times to prevent them from playing with the product.

9 PROPOSITION 65



WARNING

This product contains a chemical known to the state of California to cause cancer, birth defects or other reproductive harm. Some dust created by power sanding, sawing, grinding, drilling, and other construction activities contains chemicals known to cause cancer, birth defects or other reproductive harm. Some examples of these chemicals are:

- Lead from lead-based paints;
- Crystalline silica from bricks and cement and other masonry products;
- Arsenic and chromium from chemically treated lumber.

Your risk of exposure to these chemicals varies depending on how often you do this type of work. To reduce your exposure to these chemicals, work in a well-ventilated area, and work with approved safety equipment, such as dust masks that are specially designed to filter out microscopic particles.

Save these instructions.



10 SYMBOLS ON THE PRODUCT

Symbol	Explanation
	To reduce the risk of injury, user must read and understand operator's manual before using this product.
	Do not expose the product to rain or moist conditions.

Symbol	Explanation
	Always wear safety goggles or safety glasses with side shields and, as necessary, a full-face shield when operating this product.
	To reduce the risk of injection or injury, never direct a water stream towards people or pets or place any body part in the stream. Leaking hoses and fittings are also capable of causing injection injury. Do not hold hoses or fittings.
	To reduce the risk of injury from kickback, hold the spray lance securely with both hands when the product is on.
	Failure to use in dry conditions and to observe safe practices can result in electric shock.
	Fuel and its vapors are explosive and can cause severe burns or death.
	Warning! Never point the gun to human, animals, the product body, power supply or any electric appliances.
	The product is not suitable for connection to the drinking water mains without backflow preventer.
	Only use cleaning deck on flat, horizontal surfaces. Never lift cleaning deck from the cleaning surface while operating the product.
	Keep hands and feet away from the cleaning deck while the product is running.

11 RISK LEVELS

The following signal words and meanings are intended to explain the levels of risk associated with this product.

SYMBOL	SIGNAL	MEANING
	DANGER	Indicates an imminently hazardous situation, which, if not avoided, will result in death or serious injury.
	WARNING	Indicates a potentially hazardous situation, which, if not avoided, could result in death or serious injury.
	CAUTION	Indicates a potentially hazardous situation, which, if not avoided, may result in minor or moderate injury.
	CAUTION	(Without Safety Alert Symbol) Indicates a situation that may result in property damage.

12 INSTALLATION

12.1 UNPACK THE PRODUCT

 **WARNING**

Make sure that you correctly assemble the product before use.

 **WARNING**

- If parts of the product are damaged, do not use the product.
- If parts are missing, do not operate the product.
- If parts are damaged or missing, contact the service center.

1. Open the package.
2. Read the documentation provided in the box.
3. Remove all the unassembled parts from the box.
4. Remove the product from the box.
5. Discard the box and packing material in compliance with local regulations.

 **WARNING**

For your personal safety, do not insert battery before the product is assembled completely.

12.2 INSTALL THE HIGH PRESSURE HOSE

1. Uncoil the high pressure hose and attach the end of the high pressure hose to the base of spray gun. Tighten by hand.

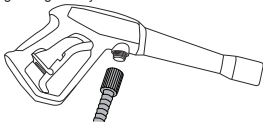

2. Attach the other end of the high pressure hose to the water outlet. Tighten by hand.

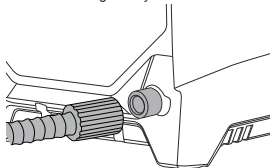

12.3 CONNECT THE WATER SUPPLY TO THE PRODUCT

For easy operation, please use a self-coiling garden hose (not provided).

 **WARNING**

When you operate the self-coiling hose, make sure that the hose has no blockage.

 **WARNING**

- The water supply must come from the water main.
- Do not use hot water.
- Do not use water from ponds or lakes.

 **WARNING**

Do the local regulations when you connect the garden hose to the water supply. Direct connection through a receiver tank or backflow preventer is usually permitted.

CAUTION

Inspect the filter in the water inlet connector before you connect the garden hose

- If the filter is damaged, do not use the product until the filter is replaced.
- If the filter is dirty, clean the filter.

1. Uncoil the garden hose.
2. Let the water flow through the garden hose for 30 seconds.
3. Turn the water supply off.
4. Install and tighten the end of the garden hose to the water inlet connector.

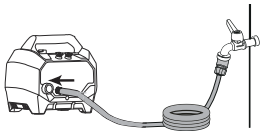

CAUTION

There must be a minimum of 3 m of free hose between the water inlet and the water supply.

12.4 INSTALL THE SPRAY WAND

1. Push the end of the spray wand into the spray gun handle.
2. Turn the spray wand until the tabs lock into position.

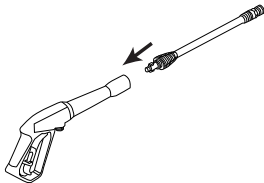

WARNING

Make sure that the connection has no leakage.

12.5 SPRAY TIPS AND NOZZLE

12.5.1 SELECT DESIRED SPRAY TIP OR NOZZLE:

NOZZLE OR SPRAY TIP SELECTION GUIDE

High pressure		Turbo rotary nozzle
		Green, gentle lifting and cleaning
		White, minimum spraying

12.5.2 INSTALL THE SPRAY TIP

1. Pull back and hold the quick-connect collar on the spray wand.

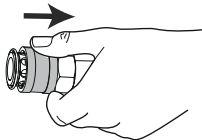

2. Insert the spray tip onto the spray wand.

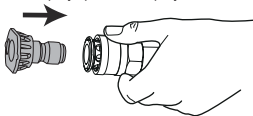

3. Release the quick-connect collar to attach the spray tip.

Note: Pull on spray tip to ensure it is properly installed and does not pull out.

13 OPERATION

WARNING

Make sure that all the connections are tight and have no leakage before operation.

13.1 PREPARE A DRIP LOOP

Recommend the use of a drip loop as below so the water can not run along the power cord even possibly reach the electrical outlet and plug.

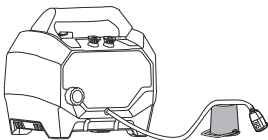

⚠ WARNING

Keep the extension cord clear of the working area. Position the cord so that it will not get caught on lumber, tools, or other obstructions while you are working with a power tool. Failure to do so can result in serious personal injury.

13.2 START THE PRODUCT

Note : *The product should be connected to a power supply. A considerable voltage drop will cause a loss of power and the motor will be overheated.*

⚠ CAUTION

Before you start the product:

1. Turn the water supply on.
2. Pull the spray gun trigger to release air pressure.
3. If a stable stream of water come into view, release the spray gun trigger.

⚠ CAUTION

DO NOT start the product without the water supply connected and turned on.

1. Connect the electrical power with plug to a suitable outlet.

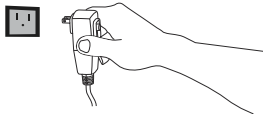

2. Set the power switch to the "ON" (I) position.

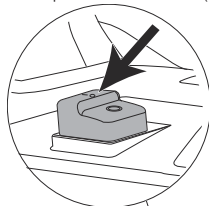

3. Turn the water supply on.
4. Push the trigger safety latch up and pull the spray gun trigger to start the spray gun.

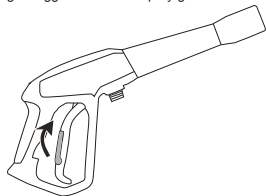

13.3 STOP THE PRODUCT

1. Release the spray gun trigger.
2. Pull the trigger safety latch down until it clicks into the slot.

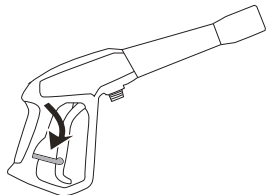

3. Set the power switch to the "OFF" (O) position.
4. Turn the water supply off.
5. Disconnect the power cord from the outlet.

Note: If you do not use the product, point the spray gun in a safe direction, and squeeze the trigger to relieve built up pressure in the product.

13.4 INSTALL THE SOAP APPLICATOR

▲ WARNING

Do not use household detergents, acids, alkalines, bleaches, solvents, flammable material, or industrial grade solutions, which can do damage to the pump.

▲ WARNING

Do the instructions on the solution bottle to prepare detergent.

Note: If it is necessary, use a funnel to prevent the spill of detergent. Clean and dry the spilled detergent when you fill it.

- Put the detergent into the soap applicator.

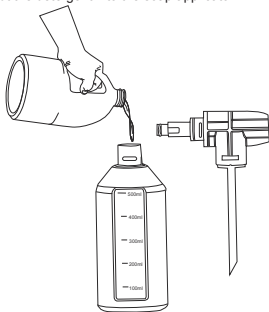

- Install the soap applicator onto the gun and tighten by hand.

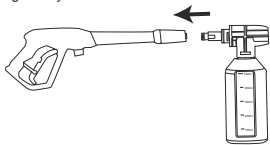

Note: Do not let detergent dry on the surface to prevent streaks.

14 MAINTENANCE

▲ WARNING

Before maintenance, make sure that you

- Stop the product.
- Wait until all the moving parts stop.
- Disconnect the plug from the power source.

▲ WARNING

Do not use strong solvents or detergents on the plastic housing or components.

▲ WARNING

Do not let brake fluids, gasoline, petroleum-based materials touch the plastic parts. Chemicals can cause damage to the plastic, and make the plastic unserviceable.

▲ WARNING

Replace the power cord by an approved service center.

14.1 PROTECT THE PUMP

- Regular use of pump protector (not included) can prolong the life of the product by removing hard water mineral deposits, lubricating pump seals and pistons, and preventing freeze damage.
- To maintain the best performance from the product, pump protector should be added to the product after every use and before long term storage.

Note: The following steps are typical for adding pump protector to the product. Always read the specific instructions provided by the manufacturer of the pump protector used before starting.

- Turn the water tap off and set the ON/OFF switch to OFF.
- Press the trigger for approximately 1 minute or until no more water escapes from the connected accessory.
- Disconnect the power cord with plug from the outlet.
- Disconnect the hose from the water inlet.
- Remove the lid from pump protector bottle and then insert the pump protector bottle into the water inlet.
- Tighten the water inlet sleeve by hand to secure the connection.
- Squeeze the pump protector bottle to inject protector fluid into product.

8. The product is protected when the protector fluid exits the water outlet.

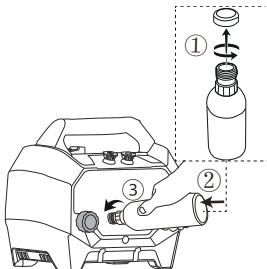

14.2 SPRAY TIP MAINTENANCE

If there is too much pump pressure, the spray tip can become clogged. You can feel a pulsing sensation while you pull the spray gun trigger.

14.2.1 REMOVE THE SPRAY TIP

1. Pull back and hold the quick-connect collar on the spray wand.
2. Remove the spray tip from the spray wand.

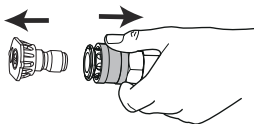

14.2.2 CLEAN THE SPRAY TIP

1. Use a straight paper clip or cleaning tool to clean the spray tip.

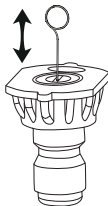

2. Flush and clean the unwanted materials out of the spray tip with the garden hose.
3. Install the clean spray tip to the spray wand.

15 TRANSPORTATION AND STORAGE

⚠ WARNING

Disconnect the power cord and water supply hose before transportation and storage.

15.1 MOVE THE PRODUCT

- Point the spray wand in a safe direction.
- Only hold the product with the handgrip.

15.2 STORE THE PRODUCT

⚠ WARNING

Make sure that the spray gun, the high-pressure hose and the product are dry.

⚠ WARNING

Make sure the product is out of the reach of children.

- Disconnect the garden hose from product.
- Wind the power cord and the high-pressure hose.
- Clean housing and the plastic components with a moist and soft cloth.
- Make sure that the product does not have loose or damaged parts. If it is necessary, follow these steps/instructions:
 - Replace the damaged parts.
 - Tighten the bolts.
 - If needed, call the customer service phone number for servicing instructions.
- Store the product in a dry, isolated and frost-free area.

16 TROUBLESHOOTING

PROBLEM	POSSIBLE CAUSE	SOLUTION
The motor does not start.	The power button is in the "OFF" (O) position.	Set the power switch to the "ON" (I) position.
	The power cord is not plugged in.	Connect the power cord to the power supply.
	Electrical outlet does not supply sufficient power.	Try another electrical outlet.
	The circuit breaker is tripped.	Let it cool, and start the product again.
	The power switch is on, but you do not pull the spray gun trigger.	Pull the spray gun trigger.
The product does not reach high pressure.	The diameter of garden hose is too small.	Replace with a 1" (25 mm) or 5/8" (16 mm) garden hose.
	Water supply is restricted.	Check garden hose for kinks, leaks, and blockage.
	The water supply is not sufficient.	Turn on the water supply fully.
	Spray tip has not be installed onto the spray wand properly.	Install desired spray tip to end of wand.
	The water intake filter is clogged.	Remove filter and rinse in warm water.
The output pressure varies high and low.	The water supply is not sufficient.	Turn on the water supply fully. Check garden hose for kinks, leaks, or blockage.
	The pump is drawing in air.	<ol style="list-style-type: none"> 1. Make sure that the hoses and fitting are airtight. 2. Turn "OFF" product. 3. Purge pump by squeezing trigger gun until a steady flow of water comes out the spray tip.
	The water intake filter is clogged.	Remove the filter and rinse in warm water.
	The supply voltage is low.	Make sure that only the pressure washer is running on the circuit.
	The gun, hose or nozzle are calcified.	Run distilled vinegar through detergent tank.
The motor buzzes, but the product does not start.	The supply voltage is low.	Make sure that only the pressure washer is running on the circuit.
	The pump system has residual pressure.	<ol style="list-style-type: none"> 1. Turn "OFF" the product. 2. Pull the spray gun trigger on spray wand to release pressure. 3. Turn the product "ON".

PROBLEM	POSSIBLE CAUSE	SOLUTION
	Voltage loss due to use of an improper extension cord.	Disconnect the extension cord, and connect the product directly into the outlet.
	Pressure washer not used for long periods.	Call customer service.
	Residual friction among components, product might emit a humming noise.	<ol style="list-style-type: none"> 1. Disconnect the water supply. 2. Power "ON" the product for 2 to 3 seconds. 3. Repeat the above step a couple of times or until the motor starts.
There is no water.	The water supply is off.	Turn the water supply on.
	The garden hose is kinked.	Remove kink in garden hose.

17 TECHNICAL DATA

Universal Motor	120V 60HZ 13A
Max. Pounds Per Square Inch Pressure	1900 PSI
Rated Gallons Per Minute	1.2 GPM
Maximum Inlet Water Temperature	104 °F (40 °C)
Cleaning Units	2280 C.U.
	Double-insulated construction.

18 LIMITED WARRANTY

90-Day Warranty

Renewed/Refurbished products and batteries are protected against all defects in materials, parts or workmanship under normal use for a period of 90 days from the shipping date or in-store purchase date. All sales are final, no returns.

ITEMS NOT COVERED BY WARRANTY:

1. Any part that has become inoperative due to misuse, commercial use, abuse, neglect, accident, improper maintenance, or alteration; or
2. The unit, if it has not been operated and/or maintained in accordance with the owner's manual; or
3. Normal wear;
4. Routine maintenance items such as lubricants, blade sharpening;
5. Normal deterioration of the exterior finish due to use or exposure.

HELPLINE:

Warranty service is available by calling our toll-free helpline at 1-888-909-6757.

TRANSPORTATION CHARGES:

Transportation charges for the movement of any power equipment unit or attachment are the responsibility of the purchaser. It is the purchaser's responsibility to pay transportation charges for any part submitted for replacement under this warranty unless such return is requested in writing by Greenworks.

USA address:

Greenworks Tools

P.O. Box 1238, Mooresville, NC 28115

Canadian address:

Greenworks Tools Canada, Inc.

P.O. Box 93095, Newmarket, Ontario, L3Y 8K3

Mexico address:

TECNOLOGIA CAMPO Y JARDIN S.A. DE C.V.

ADMINISTRADORES No. 5336 A, COL. ARCOS DE
GUADALUPE, ZAPOPAN , JALISCO , C.P. 45037

www.greenworkstools.com



greenworks

Rev B2



P0605122-00