

# greenworks®

EN

STRING TRIMMER

OPERATOR MANUAL

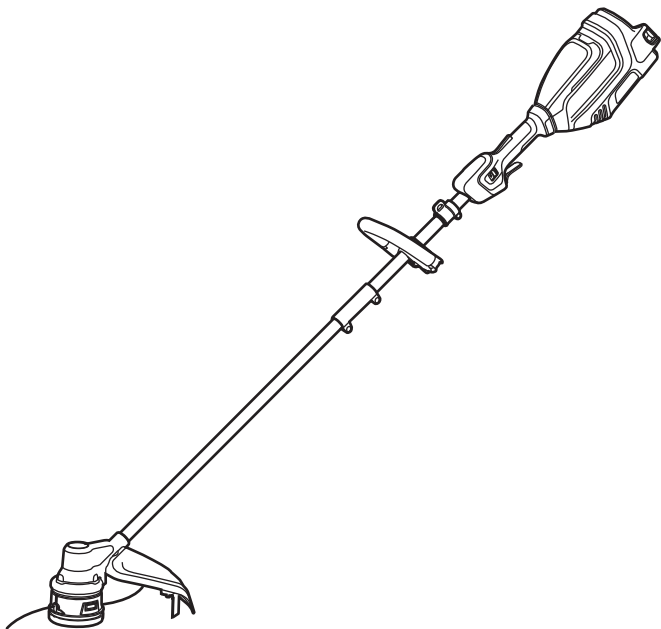

**STB415**

[www.greenworkstools.com](http://www.greenworkstools.com)



<b>1</b>	<b>Introduction.....</b>	<b>4</b>	5.2	Operate the product.....	9
1.1	Product description.....	4	5.3	Stop the product.....	10
1.2	Intended use.....	4	<b>6</b>	<b>Maintenance.....</b>	<b>11</b>
1.3	Product overview.....	4	6.1	Examine the battery and the battery charger.....	11
1.4	Symbols on the machine.....	4	6.2	Clean the product, the battery, and the battery charger....	11
1.5	California Proposition 65.....	5	6.3	Replace the spool.....	11
<b>2</b>	<b>Safety.....</b>	<b>5</b>	6.4	Install the cutting line.....	12
2.1	Safety definitions.....	5	<b>7</b>	<b>Transportation, storage, and disposal.....</b>	<b>13</b>
2.2	Important safety instructions.....	5	7.1	Transportation and storage.....	13
2.3	Inspect safety features.....	6	7.2	Disposal of the battery, battery charger, and product.....	13
<b>3</b>	<b>Service.....</b>	<b>7</b>	<b>8</b>	<b>Troubleshooting.....</b>	<b>13</b>
<b>4</b>	<b>Assembly.....</b>	<b>7</b>	<b>9</b>	<b>Technical data.....</b>	<b>14</b>
4.1	Install the Trimmer guard.....	7	<b>10</b>	<b>Limited warranty.....</b>	<b>14</b>
4.2	Assemble the shaft.....	7			
4.3	Install the auxiliary handle.....	8			
4.4	Attach the shoulder strap.....	8			
<b>5</b>	<b>Operation.....</b>	<b>8</b>			
5.1	Before you use the product.....	8			

## 1 INTRODUCTION

### 1.1 PRODUCT DESCRIPTION

This product is a battery-operated string trimmer with an electrical motor.

We are committed to continuously improving our products, and reserve the right to modify the design and appearance without prior notice.

### 1.2 INTENDED USE

This product is designed to cut, trim, and clear different types of vegetation using the trimmer head. It should not be used for any other tasks.

Please note that national or local regulations may regulate the use of the product. It is important to comply with any regulations given.

Always use accessories that are approved by the manufacturer with this product.

### 1.3 PRODUCT OVERVIEW

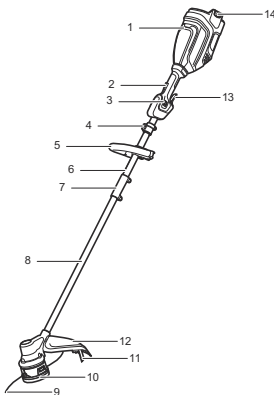

- 1 Battery compartment
- 2 Safety-lock button
- 3 Speed switch
- 4 Strap bracket
- 5 Auxiliary handle
- 6 Upper shaft
- 7 Coupler
- 8 Lower shaft
- 9 Cutting line

- 10 Trimmer head
- 11 String cut-off blade
- 12 Trimmer guard
- 13 Trigger
- 14 Battery release button

### 1.4 SYMBOLS ON THE MACHINE

Some of the following symbols can be used on this machine. Please study them and learn their definition. Proper interpretation of these symbols will let you operate the tool better and safer.

Symbol	Explanation
V	Voltage
A	Current
Hz	Frequency (cycles per second)
W	Power
min	Time
/min	Revolutions, strokes, surface speed, orbits etc., per minute
---	Direct current
	Precautions that involve your safety.
	Read and understand all instructions before you operate the machine and follow all warnings and safety instructions.
	Always wear safety glasses with side shields marked to comply with ANSI Z87.1 when you operate this machine.
	Do not expose the machine to rain or moist conditions.
	Keep all bystanders at least 50-ft away.
	Do not install or use any type of blade on the machine or displaying this symbol.
	Thrown objects can ricochet and result in personal injury or property damage.

## 1.5 CALIFORNIA PROPOSITION 65

 WARNING

**THIS PRODUCT CONTAINS OR EMITS A CHEMICAL KNOWN TO THE STATE OF CALIFORNIA TO CAUSE CANCER OR BIRTH DEFECTS OR OTHER REPRODUCTIVE HARM.**

## 2 SAFETY

## 2.1 SAFETY DEFINITIONS

Warnings, cautions, and notes are used to point out especially important parts of the manual.

 WARNING

**THERE IS A RISK OF INJURY OR DEATH FOR THE OPERATOR OR BYSTANDERS IF THE INSTRUCTIONS IN THE MANUAL ARE NOT OBEYED.**

 CAUTION

**THERE IS A RISK OF DAMAGE TO THE PRODUCT, OTHER MATERIALS, OR THE ADJACENT AREA, IF THE INSTRUCTIONS IN THE MANUAL ARE NOT OBEYED.**

*Note: Used to give more information that is necessary in a given situation.*

## 2.2 IMPORTANT SAFETY INSTRUCTIONS

**READ ALL INSTRUCTIONS BEFORE USING (THIS POWER TOOL)**

 WARNING

**READ AND UNDERSTAND ALL INSTRUCTIONS BEFORE USING THIS PRODUCT. FAILURE TO FOLLOW ALL INSTRUCTIONS LISTED BELOW MAY RESULT IN ELECTRIC SHOCK, FIRE, AND/OR SERIOUS PERSONAL INJURY.**

- Use only identical manufacturer's replacement parts and accessories. Use of any other parts may create a hazard or cause product damage.
- Always wear safety glasses with side shields marked to comply with ANSI Z87.1. Everyday glasses have only impact resistant lenses. They are NOT safety glasses. Following this rule will reduce the risk of eye injury. Use face mask if operating in dusty workspaces.
- Avoid Dangerous Environment – Don't expose power tools to damp or wet conditions. Water entering a power tool will increase the risk of electric shock.
- Don't use in rain.
- Keep all bystanders, children, and pets at least 50 ft. away.
- Dress Properly – Do not wear loose clothing or jewelry. They can be caught in moving parts. Use of protective gloves and footwear is recommended when working outdoors. Wear protective hair covering to contain long hair.
- Use right Appliance. Do not use appliance for any job except that for which it is intended.
- Avoid Unintentional Starting – Avoid holding finger on the power switch when unit has battery inserted and is not in use. Carrying this unit with finger on switch when battery is inserted increases likelihood of accident.
- Don't Force Appliance – It will do the job better and with less likelihood of a risk of injury at the rate for which it was designed.
- Don't overreach – Keep proper footing and balance at all times.
- Stay alert – Watch what you are doing. Use common sense. Do not operate this unit when you are tired, ill or under the influence of alcohol, drugs, or medication.
- Always store idle power tools indoors – When not in use, power tools should be stored indoors in a dry and high or locked-up place, out of reach of children.
- The machine is not intended for use by persons (including children) with reduced physical, sensory, or mental capabilities, or lack of experience and knowledge, unless they have been given supervision or instruction concerning use of the machine by a person responsible for their safety. Children should be supervised to ensure that they do not play with the machine.
- Maintain Appliance With Care – Replace string head if cracked, chipped, or damaged in any way. Be sure the string head is properly installed and securely fastened. Keep cutting edge sharp and clean for best performance and to reduce the risk of injury. Follow instructions for lubricating and changing accessories. Inspect appliance cord periodically, and if damaged, have it repaired by an authorized service facility. Inspect extension cords periodically and replace if damaged. Keep handles dry, clean, and free from oil and grease. Failure to do so can cause serious injury.
- Check damaged parts before using the appliance, a guard or other part that is damaged should be carefully checked to determine that it will operate properly and perform its intended function. Check for alignment of moving parts, binding of moving parts, breakage of parts, damaged mountings, and any other condition that may affect its operation. A guard or other part that is damaged should be properly repaired or replaced by an authorized

service center unless indicated elsewhere in this manual.

- Remove or disconnect battery before servicing, cleaning, or removing material from the gardening appliance.
- Do not modify or attempt to repair the appliance or the battery pack (as applicable) except as indicated in the instructions for use and care. Use appliances only with specifically designated battery packs. Use of any other battery packs may create a risk of injury and fire. Use only with Greenworks BAB740 battery or other BAB series.
- Recharge only with the charger specified by the manufacturer. A charger that is suitable for one type of battery pack may create a risk of fire when used with another battery pack. Use only with Greenworks GCH8020 charger or other CAB series.
- When battery pack is not in use, keep it away from other metal objects, like paper clips, coins, keys, nails, screws, or other small metal objects, that can make a connection from one terminal to another. Shorting the battery terminals together may cause a fire.
- Under abusive conditions, liquid may be ejected from the battery; avoid contact. If contact accidentally occurs, flush with water. If liquid contacts eyes, additionally seek medical help. Liquid ejected from the battery may cause irritation or burns.
- Do not use a battery pack or appliance that is damaged or modified. Damaged or modified batteries may exhibit unpredictable behavior resulting in fire, explosion, or risk of injury.
- Do not expose a battery pack or appliance to fire or excessive temperature. Exposure to fire or temperature above 265 °F (130 °C) may cause an explosion.
- Do not dispose of the batteries in a fire. The cells may explode. Check with local codes for possible special disposal instructions.
- Do not open or mutilate the batteries. Released electrolyte is corrosive and may cause damage to the eyes or skin. It may be toxic if swallowed.
- Exercise care in handling batteries in order not to short the battery with conducting materials such as rings, bracelets, and keys. The battery or conductor may overheat and cause burns.
- Follow all charging instructions and do not charge the battery pack or appliance outside of the temperature range specified in the instructions. Charging improperly or at temperatures outside of the specified range may damage the battery and increase the risk of fire.
- Have servicing performed by a qualified repair person using only identical replacement parts. This will ensure that the safety of the product is maintained.

- Keep guards in place and in working order.
- Keep hands and feet away from cutting area.
- Disconnect the battery pack from the appliance before making any adjustments, changing accessories, or storing appliance. Such preventive safety measures reduce the risk of starting the appliance accidentally.
- Use only with the nylon cutting line of 0.095" (2.4 mm) diameter. Do not use heavier lines than recommended by the manufacturer and line materials of other types – for example, metal wire, rope, and the like.

## SAVE THESE INSTRUCTIONS

### 2.3 INSPECT SAFETY FEATURES

- Examine the work area to identify any potential hazards, such as uneven terrain, slopes, rocks, branches, or ditches.
- Perform all required safety inspections, maintenance, and servicing as specified in this manual.
- Check that all covers, guards, handles, and cutting equipment are properly attached and undamaged.
- Check the cutting attachment and cutting attachment guard for any damage or cracks and replace if necessary.

#### 2.3.1 CHECK THE SAFETY-LOCK BUTTON AND TRIGGER

The safety-lock button is designed to prevent accidental operation. See **Product overview** to find where these parts are located on your product.

1. Make sure that the trigger is locked when the safety-lock button is not pressed.
2. Make sure that the trigger and safety-lock button move freely and that the return spring works correctly.
3. Simultaneously push the safety-lock button and pull the trigger to start the product.
4. Test on high-speed mode.
5. Release the trigger and make sure that the cutting attachment stops completely.

#### 2.3.2 CHECK CUTTING ATTACHMENT GUARD

The cutting attachment guard is a crucial safety device that prevents objects from being thrown towards the operator and prevents injury if the cutting attachment is touched.

**⚠ WARNING**

**DO NOT USE A CUTTING ATTACHMENT WITHOUT AN APPROVED AND CORRECTLY ATTACHED CUTTING ATTACHMENT GUARD. ALWAYS USE THE RECOMMENDED CUTTING ATTACHMENT GUARD FOR THE CUTTING ATTACHMENT THAT YOU USE. USING AN INCORRECT OR FAULTY CUTTING ATTACHMENT GUARD CAN CAUSE SERIOUS PERSONAL INJURY.**

1. Stop the product and remove the battery.
2. Visually inspect for damage, such as cracks.
3. Replace the cutting attachment guard if it is damaged.

### 3 SERVICE

Servicing requires extreme care, and knowledge and must be performed only by a qualified service technician. Consult your nearest AUTHORIZED SERVICE CENTER for repair. Call 1-855-345-3934 to obtain the address. Only use identical manufacturer's replacement parts and accessories from the AUTHORIZED SERVICE CENTER.

### 4 ASSEMBLY

This section describes how to assemble and adjust the product.

**⚠ WARNING**

**CAREFULLY READ AND UNDERSTAND THE SAFETY CHAPTER AND THE ASSEMBLY INSTRUCTIONS BEFORE YOU ASSEMBLE THE PRODUCT.**

#### 4.1 INSTALL THE TRIMMER GUARD

**⚠ WARNING**

- THE STRING CUT-OFF BLADE MUST ALWAYS BE EQUIPPED ON THE TRIMMER GUARD BEFORE OPERATING THE PRODUCT.
- DO NOT TOUCH THE STRING CUT-OFF BLADE.

1. Remove the screws from the trimmer guard with a Phillips head screwdriver (not included).
2. Place the trimmer guard onto the shaft.
3. Securely tighten the screws with a Phillips head screwdriver.

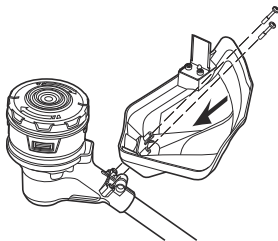

#### 4.2 ASSEMBLE THE SHAFT

1. Loosen the screw on the coupler with the hex wrench.

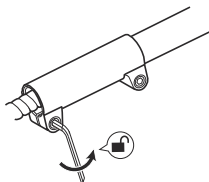

2. Push in the release button (1) on the lower shaft. Align the release button with the mounting hole (2) and slide the two shafts together.

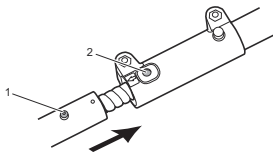

**⚠ CAUTION**

**EXERCISE CAUTION WHILE SLIDING THE TWO SHAFTS TOGETHER TO PREVENT ANY RISK OF PINCHING YOUR HANDS OR FINGERS.**

3. Turn the lower shaft until the button locks into the mounting hole.

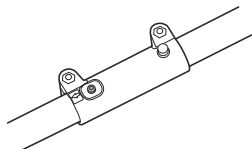

- Securely tighten the screw with the hex wrench.

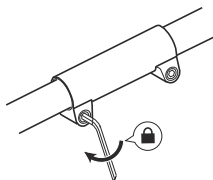

**Note:** When properly assembled, the upper and lower shaft should not separate when pulled.

**⚠ WARNING**

**CAREFULLY FOLLOW THE ASSEMBLY INSTRUCTIONS AS DESCRIBED ABOVE. FAILURE TO DO SO MAY LEAD TO THE PRODUCT SEPARATING, WHICH INCREASES THE RISK OF PERSONAL INJURY.**

#### 4.3 INSTALL THE AUXILIARY HANDLE

- Attach the auxiliary handle on the shaft.
- Place the lower clamp into the slot on the auxiliary handle.

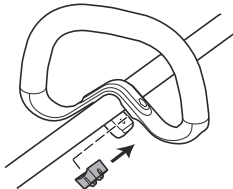

- Install the screw and the knob. Do not fully tighten.

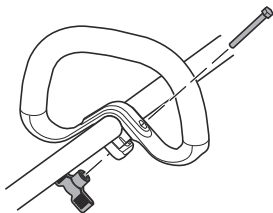

- Adjust the auxiliary handle to desired position.
- Securely tighten the wing bolt.

#### 4.4 ATTACH THE SHOULDER STRAP

- Attach the carabiner to the strap bracket on the shaft.

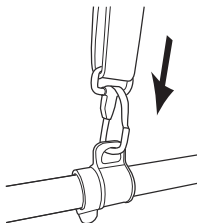

- Put on the shoulder strap.
- Adjust the length of the strap so that the carabiner is about a hand's width below your right hip.

#### 5 OPERATION

This section describes how to operate the product.

**⚠ WARNING**

**CAREFULLY READ AND UNDERSTAND THE SAFETY CHAPTER AND OPERATION INSTRUCTIONS BEFORE YOU OPERATE THE PRODUCT.**

#### 5.1 BEFORE YOU USE THE PRODUCT

##### 5.1.1 CONNECT THE BATTERY CHARGER

- Connect the battery charger to the proper voltage and frequency that is specified on the rating plate.
- Refer to the Battery Charger Operator Manual for information about how to use the battery charger.



## 5.1.2 CHARGE THE BATTERY

Refer to the Battery Charger Operator Manual for information about how to use the battery charger.

## 5.1.3 BATTERY INFORMATION

Refer to the Battery Operator Manual for information about how to use the battery.

## 5.1.4 CONNECT THE BATTERY TO THE PRODUCT

### ⚠ WARNING

**ONLY USE THE ORIGINAL BATTERY WITH THE PRODUCT.**

1. Make sure that the battery is fully charged.
2. Push the battery into the battery compartment. The battery locks into position when you hear a click.

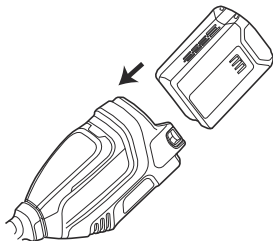

### ⚠ CAUTION

**IF THE BATTERY DOES NOT FIT EASILY INTO THE BATTERY HOLDER, IT MAY NOT BE INSTALLED CORRECTLY, WHICH CAN CAUSE DAMAGE TO THE BATTERY AND/OR THE PRODUCT.**

3. Make sure that the battery is installed securely.

## 5.1.5 START THE PRODUCT

1. Simultaneously push the safety-lock button (1) and pull the trigger (2).

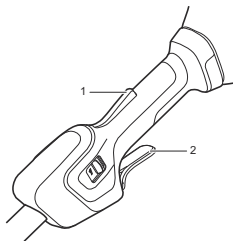

2. Adjust the speed according to the grass condition by sliding the speed switch.

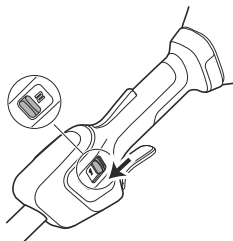

## 5.2 OPERATE THE PRODUCT

### 5.2.1 ADJUST THE LENGTH OF THE CUTTING LINE

When the cutting line becomes short during operation, bump the trimmer head on a hard, flat surface to extend more cutting line out. It is recommended to operate the product on high-speed mode for dense work areas.

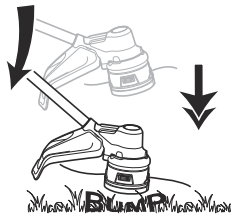

This trimmer is equipped with a string cut-off blade on the trimmer guard. The string cut-off blade

continuously trims the line to ensure a consistent and efficient cutting diameter. This will maintain best performance and keep line long enough to advance properly.

### 5.2.2 ADJUST THE CUTTING DIAMETER

**Note:** The cutting diameter of the product is set to 15 in. (38.1 cm), but it can be modified to 17 in. (43.2 cm) for a larger cutting area or kept at 15 in. (38.1 cm) for longer runtime.

1. First, start by removing the battery.
2. Unscrew the blade screws securing the string cut-off blade with the hex key.
3. Turn the string cut-off blade 180°.
4. Securely tighten the blade screws.

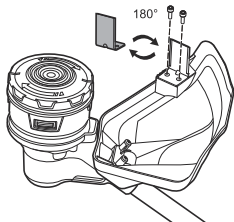

### 5.2.3 TRIM GRASS WITH A TRIMMER HEAD

#### Trim the grass

1. Hold the trimmer head above the ground at an angle. Do not push the cutting line into the grass.

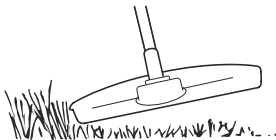

2. Decrease the speed to decrease the risk of damage to plants.
3. Use low-speed mode when cutting grass near objects.

#### Clear the grass

1. Keep the trimmer head above the ground.
2. Tilt the trimmer head.
3. Cut with the end of the cutting line around objects in the work area.

### CAUTION

**OTHER OBJECTS THAT ARE HIT BY THE CUTTING LINE, INCREASE THE WEAR ON THE CUTTING LINE.**

4. Use low-speed mode when cutting and clearing vegetation. This decreases the wear on the trimmer head and cutting line.

#### Cut the grass

1. Make sure that the cutting line is parallel to the ground.

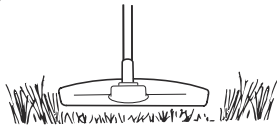

2. Do not push the trimmer head to the ground as this can cause damage to the product.
3. Move the product from side to side when you cut grass. Use high-speed mode for optimal performance.

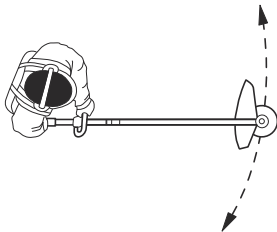

#### Sweep the grass

The airflow from the rotating cutting line can be used to remove cut grass from an area.

1. Hold the trimmer head and the cutting line parallel to the ground and above the ground.
2. Use on high-speed mode.
3. Move the trimmer head from side to side to sweep the grass.

### 5.3 STOP THE PRODUCT

1. Release the trigger.
2. Push the battery release button and pull out the battery to fully stop its operation.

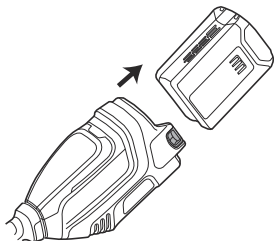

WARNING

**WAIT UNTIL THE MOTOR STOPS BEFORE YOU REMOVE THE BATTERY.**

## 6 MAINTENANCE

This section describes how to maintain the battery, battery charger, and product.



WARNING

**CAREFULLY READ AND UNDERSTAND THE SAFETY CHAPTER AND OPERATION INSTRUCTIONS BEFORE YOU DO ANY MAINTENANCE WORK.**

### Before you do maintenance:

- Stop the product.
- Remove the battery.
- Allow the motor to cool.
- Use correct clothing, protective gloves, and safety glasses.

### 6.1 EXAMINE THE BATTERY AND THE BATTERY CHARGER

Carefully inspect the battery, battery charger, and connection cord of the battery charger for any signs of damage, such as cracks or broken parts. Replace if necessary.

### 6.2 CLEAN THE PRODUCT, THE BATTERY, AND THE BATTERY CHARGER

- Clean the product after each use with a moist cloth and neutral detergent.
- Do not use strong detergents or solvents like "glass cleaner" to clean the plastic parts or handles.
- Keep the trimmer head free from grass, leaves, or excessive grease.
- Keep the air vents clean and free of debris to avoid overheating and damage to the motor.

- Do not spray water on the motor and electrical components.
- Clean the battery and battery charger with a dry cloth. Keep the battery guide tracks clean.
- Prior to inserting the battery into the battery charger, ensure that the terminals on both the battery and the battery charger are clean.

### 6.3 REPLACE THE SPOOL

**Note:** For normal use, head disassembly is not necessary. However, if circumstances require disassembly, follow these instructions.

1. Push the two tabs on the sides of the trimmer head at the same time.

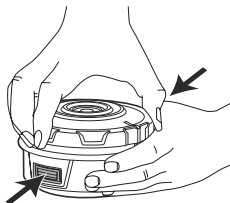

2. Pull and remove the spool cover assembly.

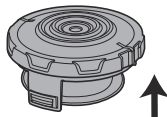

3. Remove the remaining cutting line and thoroughly clean any dirt or debris from all parts.
4. Remove screws (1), spool (2), slot cover (3), and location housing (4) from the spool cover (5).

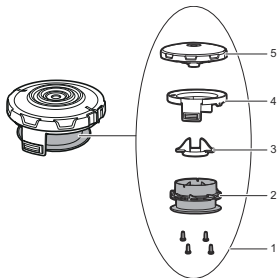

5. Replace with a new spool.

**Note:** If any parts of the spool assembly are damaged or worn, replace the damaged part and reassemble them as pictured in Step 4.

6. Place the location housing and slot cover onto the spool cover, then put the spool onto the slot cover to the desired position.
7. Tighten with the screws.
8. Align the spool tabs with the tab openings on the spool housing.
9. Push the spool cover assembly until it clicks into position.

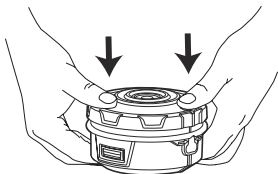

#### 6.4 INSTALL THE CUTTING LINE

**Note:** Do not use more than 23 ft. (7 m) of 0.095" (2.4 mm) cutting line at a time.

1. Remove any leftover cutting line from the trimmer head.
2. Push and turn the spool cover. Ensure that the slot (1) on the spool cover aligns with the line exit hole on the trimmer head.

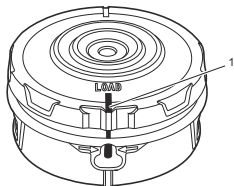

3. Feed the cutting line through the hole and push it until it exits the opposite hole.

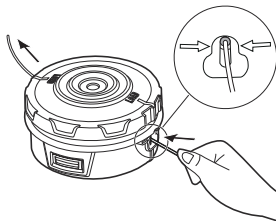

4. Pull the cutting line through until there is an equal amount of cutting line on each side.

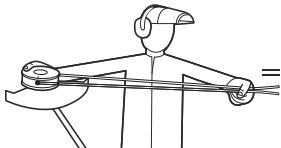

5. Turn the spool cover clockwise to wind the cutting line into the trimmer head. Keep approximately 5" of cutting line above out of each side of the trimmer head.

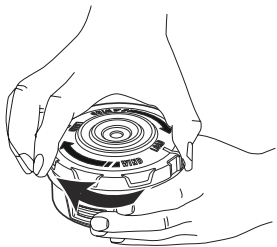

## 7 TRANSPORTATION, STORAGE, AND DISPOSAL

### 7.1 TRANSPORTATION AND STORAGE

- Follow special packaging and labeling requirements for commercial transportation, including by third parties and forwarding agents.
- Seek advice from a person with special training in dangerous materials before shipping the product and comply with all applicable national regulations.
- Use tape on open contacts when packaging the battery and ensure it is securely packed to prevent movement.
- Remove the battery before storing or transporting the product.
- Store the battery and battery charger in a dry, moisture-free, and frost-free space.
- Avoid storing the battery in an area where static electricity may occur, and do not store in a metal box.
- Charge the battery 30% to 50% before long-term storage.
- Store the battery charger in a closed and dry space.
- Keep the battery away from the battery charger during storage, and ensure that unauthorized persons, including children, do not touch the equipment. Store the equipment in a lockable space.
- Clean the product and perform full servicing before long-term storage.
- Use transportation guards on the product to prevent injury or damage during transportation and storage.
- Securely stow the product during transport to ensure safe handling.

### 7.2 DISPOSAL OF THE BATTERY, BATTERY CHARGER, AND PRODUCT

Symbols on the product or the package of the product mean that the product is not domestic waste. Recycle it at a recycling station for electrical and electronic equipment. This helps to prevent damage to the environment and persons.

Get in touch with your local authorities, domestic waste service, or your dealer for more information about how to recycle your product.

## 8 TROUBLESHOOTING

Problem	Possible Cause	Solution
The product does not start when the	No electrical contact between the product and the battery.	<ol style="list-style-type: none"> <li>Remove battery.</li> <li>Inspect the metal contacts and re-insert the battery.</li> </ol>

Problem	Possible Cause	Solution
trigger is pulled.	The battery is depleted.	Charge the battery pack.
	The safety-lock button and trigger are not operated at the same time.	<ol style="list-style-type: none"> <li>Push the safety-lock button and hold it.</li> <li>Pull the trigger to start the product.</li> </ol>
The product stops when you are cutting.	The guard is not attached to the trimmer head.	Remove the battery and attach the guard to the trimmer head.
	Cutting line is too heavy.	Use only with the nylon cutting line of 0.095" (2.4 mm) diameter.
	The grass becomes tangled around the motor shaft or the trimmer head.	<ol style="list-style-type: none"> <li>Stop the product.</li> <li>Remove the battery.</li> <li>Remove the grass from the motor shaft and trimmer head.</li> </ol>
	The motor is overloaded.	<ol style="list-style-type: none"> <li>Pull the trimmer head away from the grassy area.</li> <li>Allow the product to cool for at least 10 minutes.</li> <li>Cut in stages and guide the trimmer head in and out of the grass, making sure not to cut more than 8" per pass.</li> </ol>
	The battery or product is too hot.	<ol style="list-style-type: none"> <li>Allow the battery or product to cool for at least 10 minutes. Remove the battery from the product to help the product cool down more quickly.</li> </ol>
	The battery pack is disconnected from the product.	Install the battery again.

Problem	Possible Cause	Solution
	The battery pack is depleted.	Charge the battery pack.
The cutting line does not extend.	Lines are interlocked.	<ol style="list-style-type: none"> <li>1. Remove the interlocked lines.</li> <li>2. Rewind the lines.</li> </ol>
	Not enough line on spool.	Install more line.
	Lines are worn too short.	<ol style="list-style-type: none"> <li>1. Remove the battery.</li> <li>2. Press and hold the bump head.</li> <li>3. Pull out lines manually.</li> </ol>
	Lines are tangled on spool.	<ol style="list-style-type: none"> <li>1. Remove the lines from the spool.</li> <li>2. Wind the lines.</li> </ol>
The cutting line keeps breaking.	The product is used incorrectly.	<ol style="list-style-type: none"> <li>1. Cut with the tip of the line, avoid stones, walls, and other hard objects.</li> <li>2. Advance the cutting line regularly to keep full cutting width.</li> </ol>
The grass becomes tangled around the trimmer head and motor housing.	Grass too high.	<ol style="list-style-type: none"> <li>1. Cut in stages.</li> <li>2. Cut no more than 8" in each pass to prevent tangling.</li> </ol>
The cutting line is improperly cut.	The string cut-off blade becomes dull.	Sharpen the string cut-off blade with a file or replace it.
Too much vibration.	The line is worn down at one side and not advanced in time.	Make sure that the line on both sides is not damaged. Extend the line.
	The trimmer head is worn down.	Replace with a new trimmer head.
	The line has run out.	Install more line.

## 9 TECHNICAL DATA

Type	Cordless, battery powered
Motor	80V Brushless
No load speed	4900/5800 ± 10% RPM
Cutting line diameter	0.095" (2.4 mm)
Cutting width	15 in. / 17 in. (38.1 cm / 43.2 cm)
Line feeding system	Bump Feed
Battery model	BAB740 and other BAB series
Charger model	GCH8020 and other CAB series

### The recommended ambient temperature range:

Condition	Temperature
Product storage	32°F (0°C) - 113°F (45°C)
Product operation	32°F (0°C) - 113°F (45°C)
Battery charging	39°F (4°C) - 104°F (40°C)
Charger operation	39°F (4°C) - 104°F (40°C)
Battery storage	32°F (0°C) - 113°F (45°C)
Battery discharging	32°F (0°C) - 113°F (45°C)

## 10 LIMITED WARRANTY

### 90-Day Warranty

Renewed/Refurbished products and batteries are protected against all defects in materials, parts or workmanship under normal use for a period of 90 days from the shipping date or in-store purchase date. All sales are final, no returns.

**ITEMS NOT COVERED BY WARRANTY:**

1. Any part that has become inoperative due to misuse, commercial use, abuse, neglect, accident, improper maintenance, or alteration; or
2. The unit, if it has not been operated and/or maintained in accordance with the operator manual; or
3. Normal wear;
4. Routine maintenance items such as lubricants, blade sharpening;
5. Normal deterioration of the exterior finish due to use or exposure.

**HELPLINE:**

Warranty service is available by calling our toll-free helpline, at 1-855-345-3934.

**TRANSPORTATION CHARGES:**

Transportation charges for the movement of any power equipment unit or attachment are the responsibility of the purchaser. It is the purchaser's responsibility to pay transportation charges for any part submitted for replacement under this warranty unless such return is requested in writing by Greenworks.

**USA address:**

Greenworks Tools

P.O. Box 1238, Mooresville, NC 28115

**Canadian address:**

Greenworks Tools Canada, Inc.

P.O. Box 93095, Newmarket, Ontario, L3Y 8K3

**Mexico address:**

TECNOLOGIA CAMPO Y JARDIN S.A. DE C.V.

ADMINISTRADORES No. 5336 A, COL. ARCOS DE GUADALUPE, ZAPOPAN , JALISCO , C.P. 45037

# greenworks<sup>®</sup>

[www.greenworkstools.com](http://www.greenworkstools.com)



P0805308-00