

greenworks[®]

SS80L2510
SS80L02
SS80L251CO
2600041

EN

SNOW SHOVEL

OPERATOR MANUAL

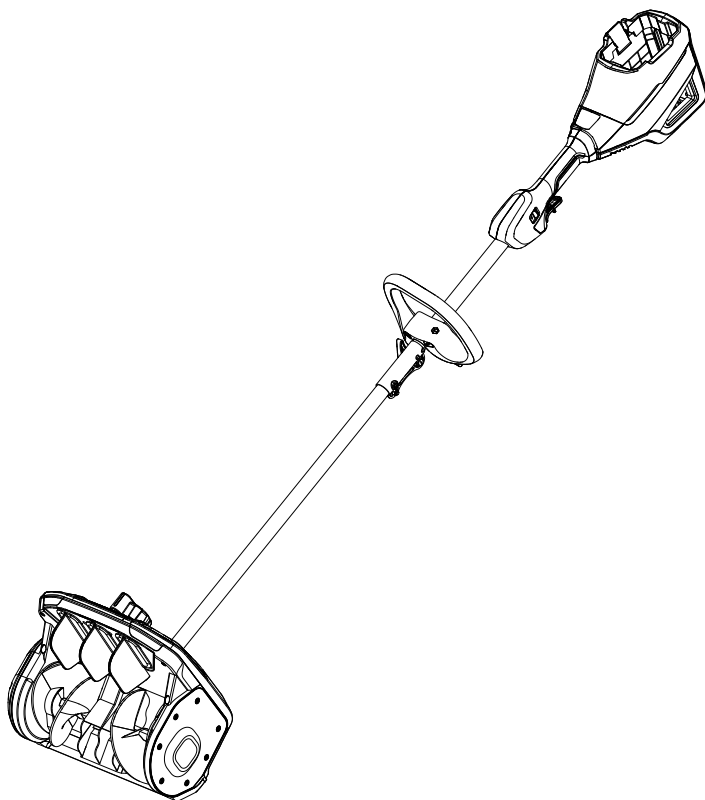

SSB407

www.greenworkstools.com

1	Description.....	4	10.6	LED Headlights.....	10
1.1	Purpose.....	4	10.7	Adjust the speed.....	10
1.2	Overview.....	4	10.8	Adjust the directionl vanes.....	10
2	Safety.....	4	10.9	Stop the machine.....	11
2.1	Safe Operation Practices for Product.....	4	10.10	Cold weather operation.....	11
3	Safety features on the product.....	6	10.11	Prevent freeze-up after use.....	11
4	Safety instructions for maintenance.....	6	10.12	Recommendations for effective snow throwing.....	11
5	Symbols on the product.....	6	11	Maintenance.....	11
6	Risk levels.....	6	11.1	Maintenance schedule.....	11
7	Environmentally safe battery disposal.....	7	11.2	General inspection.....	12
8	California Proposition 65.....	7	11.3	Clean the product.....	12
9	Installation.....	7	11.4	Clean the battery and battery charger...	12
9.1	Unpack the machine.....	7	11.5	Replace the scraper.....	12
9.2	Attach the shaft.....	8	11.6	Replace the impeller.....	14
9.3	Attach the auxiliary handle.....	8	12	Transportation, storage, and disposal.....	19
10	Operation.....	8	12.1	Transportation.....	19
10.1	Before using the product.....	9	12.2	Disposal of the battery, battery charger, and product.....	20
10.2	Install the battery pack.....	9	13	Troubleshooting.....	20
10.3	Remove the battery pack.....	9	14	Technical data.....	20
10.4	Start the product.....	9	15	Limited warranty.....	21
10.5	Operate the machine.....	10	15.1	Items not covered by warranty.....	21
			15.2	Helpline.....	21
			15.3	Shipping.....	21

1 DESCRIPTION

1.1 PURPOSE

This machine is used to remove and clear away snow from sidewalks, driveways and other paved ground-level surfaces.

1.2 OVERVIEW

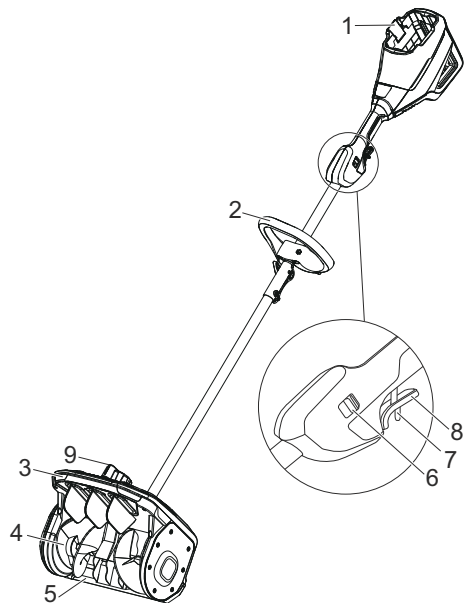

- 1 Battery release button
- 2 Auxiliary handle
- 3 LED light
- 4 Impeller
- 5 Scraper
- 6 Speed switch
- 7 Lock-out lever
- 8 Trigger
- 9 Directional vane adjustment knob

2 SAFETY

2.1 SAFE OPERATION PRACTICES FOR PRODUCT

▲ DANGER

This product has the potential to cause severe injury, including amputation of hands and feet, as well as the ejection of objects. Failure to adhere to the following safety instructions may lead to serious harm.

2.1.1 BATTERY TOOLS USE AND CARE

▲ WARNING

Read all safety warnings and instructions. Failure to follow the warnings and instructions may result in electric shock, fire and/or serious injury.

- Prevent unintentional starting. Ensure the switch is in the off-position before connecting to battery pack, picking up or carrying the product. Avoid carrying the product with your finger on the switch or powering it with your finger on the switch, as this can lead to accidents.
- Disconnect the battery pack from the product before making any adjustments, changing accessories, or storing product. Such preventive safety measures reduce the risk of starting the product accidentally.
- When battery pack is not in use, keep it away from other metal objects, like paper clips, coins, keys, nails, screws or other small metal objects, that can make a connection from one terminal to another. Shorting the battery terminals together may cause burns or a fire.
- Avoid contact with liquid that may be ejected from the battery under abusive conditions. If contact occurs, flush with water and seek medical help if it gets into the eyes. Ejected liquid from the battery can cause irritation or burns.
- Do not use a battery pack or product that is damaged or modified. Damaged or modified batteries may exhibit unpredictable behavior resulting in fire, explosion, or risk of injury.
- Do not expose a battery pack or product to fire or excessive temperature. Temperatures above 265 °F (130 °C) can cause explosion.
- Follow all charging instructions and do not charge the battery pack or product outside of the temperature range specified in the instructions. Charging improperly or at temperatures outside of the specified range may damage the battery and increase the risk of fire.
- For service or repairs, consult your nearest service center that will use identical replacement parts to ensure the safety of the product.
- Do not modify or attempt to repair the product or the battery pack (as applicable) except as indicated in the instructions for use and care.

2.1.2 FOR ALL PRODUCTS

- Do not use on graveled surfaces unless the product is adjusted for such a surface in accordance with the operator's manual.
- Keep children away - Children and bystanders should remain at a safe distance while operating the product.
- Dress Appropriately - Avoid wearing loose clothing or jewelry that can get caught in moving parts. It is recommended to wear protective footwear when using this product.
- Operation of the product in the hand-held position is unsafe, except in accordance with the special instructions for such use provided in the operator's manual.
- Keep hands away from moving parts.
- Keep guards in place and in working order.
- Avoid Overexerting the Product - The product performs better and safer when operated at its designated rate.
- Don't Overreach – Keep proper footing and balance at all times
- If the product strikes a foreign object follow these steps:
 1. Stop the product. Release the switch.
 2. Remove the battery pack.
 3. Inspect for damage.
 4. Repair any damage before restarting and operating the product.
- Disconnect Product– Disconnect the product from the battery pack when not in use, before servicing, or changing accessories.
- Store Idle Product Indoors – When not in use, products should be stored indoors in dry, locked-up place – out of reach of children.
- Maintain Products With Care – Follow instructions for lubricating and changing accessories.

2.1.3 TRAINING

- Read the operating and service instruction manual carefully. Be thoroughly familiar with the controls and the proper use of the product. Know how to stop the product and disengage the controls quickly.
- Ensure that only trained individuals operate the product, and never allow children to use it.
- Keep a clear area of operation, free from any individuals, especially small children and pets.
- Exercise caution to avoid slipping or falling, especially when operating in reverse.

2.1.4 PREPARATION

- Thoroughly inspect the area where the product is to be used and remove all doormats, sleds, boards, wires, and other foreign objects.

- Do not operate the product without wearing adequate winter garments. Wear protective footwear to improve footing on slippery surfaces.
- Adjust the collector housing height to clear gravel or crushed rock surface.
- Never attempt to make any adjustments while the product is running (except where specifically recommended by manufacturer).
- Always wear safety glasses or eye shields during operation or while making adjustments or repairs to protect eyes from foreign objects that may be thrown from the product.

2.1.5 OPERATION

- Do not put hands or feet near or under rotating parts. Keep clear of the discharge opening at all times.
- Exercise extreme caution when operating on or crossing gravel drives, walks, or roads. Stay alert for hidden hazards or traffic.
- If the product strikes a foreign object, turn the product off, remove the battery pack, and then inspect it for damage. Repair any damage before restarting and using the product.
- If the product should start to vibrate abnormally, stop the product and carefully inspect it. Vibration is generally a sign of trouble.
- Power off the product whenever you leave the operating position, before unclogging the collector/impeller housing or discharge guide, and when making any repairs, adjustments, or inspections.
- When cleaning, repairing, or inspecting, make certain the collector/impeller and all moving parts have stopped moving.
- Exercise extreme caution when operating on slopes.
- Never operate the product without proper guards, and other safety protective devices in place and in working order.
- Never direct the discharge toward people or areas where property damage can occur. Keep children and others away.
- Do not overload the product capacity by attempting to clear snow too quickly.
- Never operate the product at high transport speeds on slippery surfaces. Exercise caution when reversing.
- Make sure to power off when the product is transported or not in use.
- Use only attachments and accessories approved by the manufacturer (such as wheel weights, counterweights, or cabs).
- Never operate the product without good visibility or light. Always be sure of your footing, and keep a firm hold on the handles. Walk, don't run.
- Never use your body parts to clear the discharge chute.

- Sudden contact with the rotating impeller inside the discharge chute is the most common cause of injury associated with products. Never use your hand to clean out the discharge chute.

To clear the chute:

1. SHUT THE PRODUCT OFF!
2. Wait 10 seconds to be sure the impeller blades have stopped rotating.
3. Always use a clean-out tool, not your hands.

2.1.6 MAINTENANCE AND STORAGE

- Check shear bolts and other bolts before and after every use for proper tightness to be sure the product is in safe working condition.
- Always refer to owner's guide instructions for important details if the product is stored for an extended period.
- Maintain or replace safety and instructions labels, as necessary.
- Run the product a few minutes after throwing snow to prevent freeze-up of the collector/impeller.

2.1.7 RECOMMENDED AMBIENT TEMPERATURE RANGES:

Situation	Temperature
Product storage	1.4 °F (-17 °C) ~ 113 °F (45 °C)
Product operation	1.4 °F (-17 °C) ~ 113 °F (45 °C)
Battery charging	39 °F (4 °C) ~ 104 °F (40 °C)
Charger operation	39 °F (4 °C) ~ 104 °F (40 °C)
Battery discharging	1.4 °F (-17 °C) ~ 113 °F (45 °C)
Battery storage	32 °F (0 °C) ~ 113 °F (45 °C)

3 SAFETY FEATURES ON THE PRODUCT

▲ WARNING

CAREFULLY READ AND UNDERSTAND THE SAFETY PRECAUTIONS BELOW BEFORE USING THE PRODUCT.

- Ensure that the safety hardware on the product is functioning properly before use.
- Regularly inspect the safety hardware, and if any defects are found, please contact your nearest service center immediately.

4 SAFETY INSTRUCTIONS FOR MAINTENANCE







- Make sure to stop the motor before you do any maintenance on the product.

- Impeller blades are sharp. Wear protective gloves when doing any blade maintenance.
- Only use accessories that have been approved by the manufacturer. Do not modify the product in any way. Using unofficial or third-party accessories can result in serious injury or death.
- Failure to perform maintenance correctly and regularly increases the risk of injury and damage to the product.
- Only carry out maintenance tasks as outlined in the operator's manual. All other servicing should be performed by an authorized service center.
- Regular servicing of the product should be carried out by an approved service center.
- Replace any damaged, worn, or broken parts promptly to maintain the safety and functionality of the product.

Save these instructions



5 SYMBOLS ON THE PRODUCT

Some of the following symbols may be used on this tool. Please study them and learn their meaning. Proper interpretation of these symbols will allow you to operate the tool better and safer.

Symbol	Explanation
	Direct current
	Precautions that involve your safety.
	Read and understand all instructions before operating the product, and follow all warnings and safety instructions.
	Keep hands away from the discharge area.
	Keep feet out of impeller. Keep feet away from rotating impeller.
	Do not stare at operating lamp.

6 RISK LEVELS

The following signal words and meanings are intended to explain the levels of risk associated with this product.

SYM-BOL	SIGNAL	MEANING
	DANGER	Indicates an imminently hazardous situation, which, if not avoided, will result in death or serious injury.
	WARNING	Indicates a potentially hazardous situation, which, if not avoided, could result in death or serious injury.
	CAUTION	Indicates a potentially hazardous situation, which, if not avoided, may result in minor or moderate injury.
	CAUTION	(Without Safety Alert Symbol) Indicates a situation that may result in property damage.

7 ENVIRONMENTALLY SAFE BATTERY DISPOSAL



The toxic and corrosive materials below are in the batteries used in this product: **Lithium-ion, a toxic material.**

▲ WARNING

Discard all toxic materials in a specified manner to prevent contamination of the environment. Before discarding damaged or worn-out Lithium-ion batteries, contact your local waste disposal agency, or the local Environmental Protection Agency for information and specific instructions. Take the batteries to a local recycling and/or disposal center, certified for Lithium-ion disposal.

▲ WARNING

If the battery cracks or breaks, with or without leaks, do not recharge it and do not use. Discard it and replace with a new battery. **DO NOT TRY TO REPAIR IT!** To prevent injury and risk of fire, explosion, or electric shock, and to avoid damage to the environment:

- Cover the terminals of the battery with heavy-duty adhesive tape.
- **DO NOT** try to remove or destroy any of the battery components.
- **DO NOT** try to open the battery.
- If a leak develops, the released electrolytes are corrosive and toxic. **DO NOT** get the solution in the eyes or on skin, and do not swallow it.
- **DO NOT** put these batteries in your regular household trash.
- **DO NOT** incinerate.
- **DO NOT** put them where they will become part of any waste landfill or municipal solid waste stream.
- Take them to a certified recycling or disposal center.

8 CALIFORNIA PROPOSITION 65

▲ WARNING

THIS PRODUCT CONTAINS OR EMITS A CHEMICAL KNOWN TO THE STATE OF CALIFORNIA TO CAUSE CANCER OR BIRTH DEFECTS OR OTHER REPRODUCTIVE HARM.

9 INSTALLATION

▲ WARNING

Do not change or make accessories that are not recommended by the manufacturer.

▲ WARNING

Do not install the battery pack until you assemble all the parts.

9.1 UNPACK THE MACHINE

▲ WARNING

Make sure that you correctly assemble the machine before use.

▲ WARNING

- If parts of the machine are damaged, do not use the machine.
- If you do not have all the parts, do not operate the machine.
- If parts are damaged or missing, contact the service center.

1. Open the package.
2. Read the documentation provided in the box.
3. Remove all the unassembled parts from the box.
4. Remove the machine from the box.
5. Discard the box and packing material in compliance with local regulations.

9.2 ATTACH THE SHAFT**i NOTE**

If the button does not release fully in the location hole, the shafts are not locked into position. Turn from side to side until the button is locked into position.

1. Loosen the lock knob on the coupler (11).
2. Align the release button (9) with the location hole (10) and move the two shafts together.

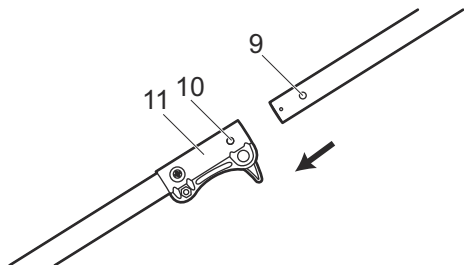

3. Turn the upper shaft until the release button (9) locks into the location hole (10).
4. Tighten the lock knob.

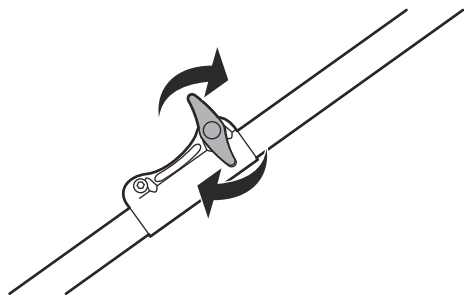
**9.3 ATTACH THE AUXILIARY HANDLE**

1. Push the auxiliary handle onto the shaft.

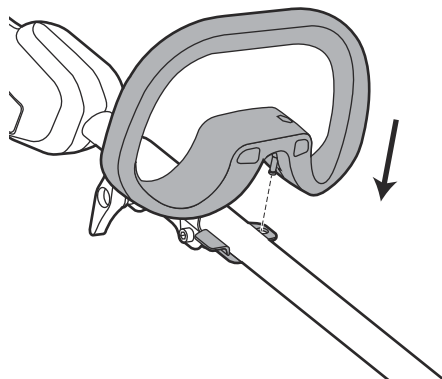

2. Set the auxiliary handle in the comfortable position.
3. Tighten the auxiliary handle with the knob.

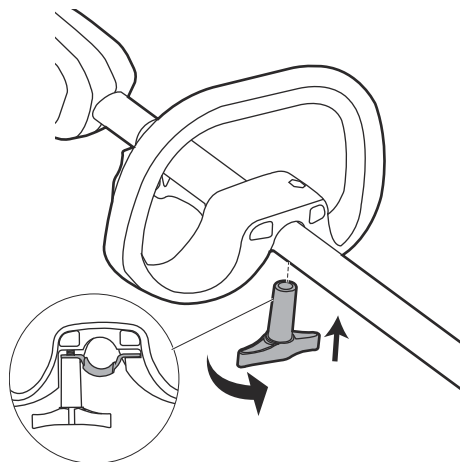
**10 OPERATION**

This section describes how to operate the product.

▲ WARNING

CAREFULLY READ AND UNDERSTAND THE SAFETY CHAPTER AND OPERATION INSTRUCTIONS BEFORE YOU OPERATE THE PRODUCT.

10.1 BEFORE USING THE PRODUCT

10.1.1 CONNECT THE BATTERY CHARGER

1. Connect the battery charger to the voltage and frequency that is specified on the rating plate.
2. Refer to the Battery Charger Operator Manual for information about how to use the battery charger.

10.1.2 CHARGE THE BATTERY

Refer to the Battery Charger Operator Manual for information about how to use the battery charger.

10.1.3 BATTERY INFORMATION

Refer to the Battery Operator Manual for information about how to use the battery.

10.2 INSTALL THE BATTERY PACK

▲ WARNING

- If the battery pack or charger is damaged, replace the battery pack or the charger.
- Stop the product and wait until the engine stops before you install or remove the battery pack.
- Read, know, and do the instructions in the battery and charger manual.

1. Align the ribs on the battery pack with the grooves in the battery compartment.
2. Push the battery pack into the battery compartment until the battery pack locks into place.

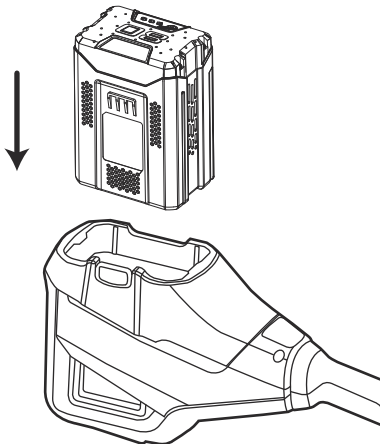

3. When you hear a click, the battery pack is installed.

10.3 REMOVE THE BATTERY PACK

1. Push and hold the battery release button.
2. Remove the battery pack from the machine.

10.4 START THE PRODUCT

▲ WARNING

Examine the work area. Remove all stones, sticks, wire, bones, and other debris that can ricochet because of the rotating impeller.

i NOTE

If it is possible, clear the snow in the direction of the wind.

1. Push and hold the lock-out button.

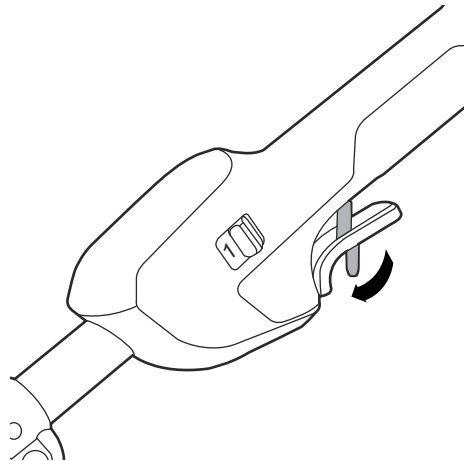

2. Pull the trigger to start the product.

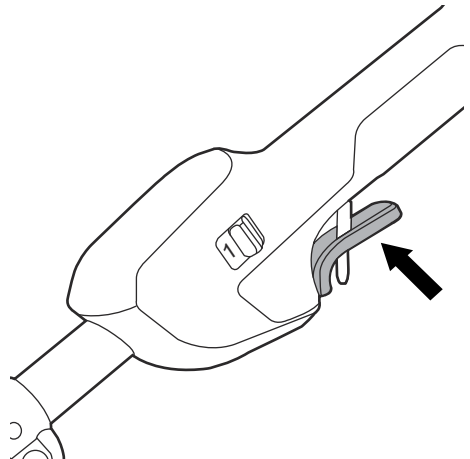

10.5 OPERATE THE MACHINE

- 1. Start the machine.
- 2. Push the machine forward until it rides on the scraper.



i NOTE
 The forward speed is dependent on the depth and weight of the snow.

10.6 LED HEADLIGHTS

- 1. The LED headlights will automatically power on when the product is turned on and power off when the product is turned off.

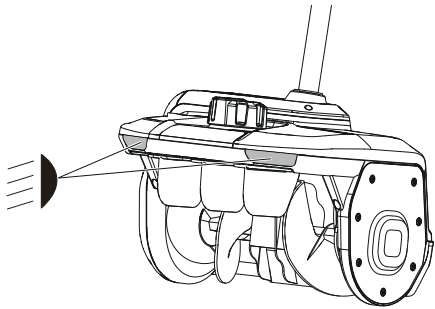

10.7 ADJUST THE SPEED

- 1. Push the speed switch to the desired operating position. Push the speed switch to position 1 for high speed or position 2 for low speed.

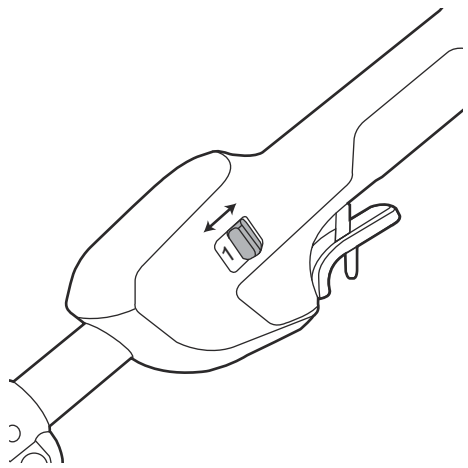

10.8 ADJUST THE DIRECTIONAL VANES

Note : The directional vanes can be adjusted 60° to alter the snow throwing direction.

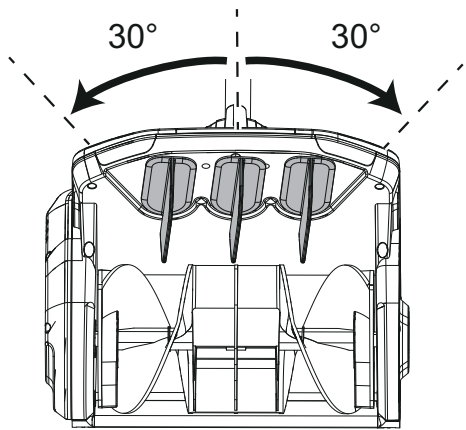

- 1. Rotate the adjustment knob to change the direction of snow throwing.

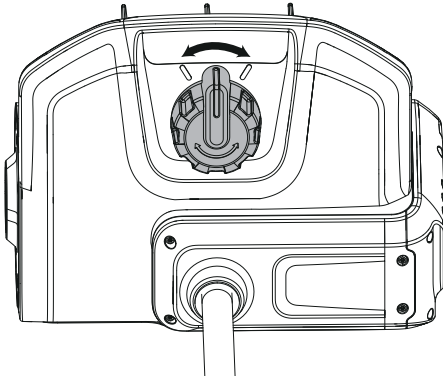

10.9 STOP THE MACHINE

1. Release the trigger to stop the machine.

10.10 COLD WEATHER OPERATION

The safe battery operation temperature ranges from 1°F (-17°C) to 113°F (45°C).

▲ WARNING

DO NOT STORE OR CHARGE BATTERY OUTSIDE.

Battery must be charged and stored indoors before using the product.

If the product does not start:

1. Remove the battery from the product.
2. Charge the battery for up to 15 minutes in a warm area, or until the charging light turns green.
3. Reinstall the battery in the unit.

11 MAINTENANCE

i IMPORTANT

Carefully read and understand the safety regulations and the maintenance instructions before you clean, repair, or do any maintenance on the product (Reference Safety regulations and maintenance instructions).

▲ WARNING

- REMOVE BATTERY OR BATTERIES FROM THE PRODUCT BEFORE YOU DO ANY MAINTENANCE.
- FAILURE TO FOLLOW PROPER MAINTENANCE SERVICE, USING THIRD-PARTY REPLACEMENT PARTS, OR MODIFYING/REMOVING COMPONENTS CAN RESULT IN INJURY TO THE USER.

11.1 MAINTENANCE SCHEDULE

The maintenance intervals are based on the assumption of daily product usage. However, if the product is not used on a daily basis, the maintenance intervals may need to be adjusted accordingly.

10.11 PREVENT FREEZE-UP AFTER USE

Note: Controls and moving parts may become obstructed by ice. Avoid applying excessive force to the controls. If a control or part becomes unresponsive, start the motor and allow it to run for a few minutes.

- Start the motor and let it run for a few minutes. Stop the engine and wait for all moving parts to come to a complete stop.
- Remove snow and loose ice from the product exterior and base of the discharge chute.
- Rotate the chute deflector to the left and right to remove ice and water.
- Press the safety switch button.

10.12 RECOMMENDATIONS FOR EFFECTIVE SNOW THROWING

- Adjust the speed of the product according to the snow conditions using the drive speed control lever. Ensure that the product evenly throws snow.
- It is recommended to remove snow promptly after it falls for easier and more efficient clearing.
- Whenever possible, throw snow downwind for optimal results.
- The scraper bar can be reversed when it becomes worn almost to the edge of the housing. Replace the scraper bar if it is damaged or worn on both sides.
- Avoid operating the chute deflector if it is clogged.
- In the event that the product does not move forward due to unforeseen circumstances, immediately release the bail lever or press the safety switch button to stop the product.

	Each use	Monthly	Each season
Perform a general inspection of the product.	x		
Clean the product.	x		
Ensure that nuts and screws are securely tightened.	x		
Ensure that safety hardware is not defective.	x		
Inspect the bail lever.	x		
Check that the safety switch button is working correctly and not defective.	x		
Remove clogging, foreign objects in impeller.	x		
Examine the battery for any damage.	x		
Ensure that the battery is charging properly.	x		
Check that the release buttons on the battery are working properly and that the battery locks into the product securely.	x		
Inspect the battery charger for any damage and ensure it is operating correctly.		x	
Check the connections between the battery and the product, as well as the connection between the battery and the battery charger.			x

11.2 GENERAL INSPECTION

- Check and tighten all nuts and screws on the product.
- Make sure to properly route and secure all cables to prevent them from being damaged.

11.3 CLEAN THE PRODUCT

- Replace any worn or damaged parts.
- Clean the product after each use with water, neutral detergent, and a soft cloth.
- Do not use a hose to spray the unit. Instead, wipe it down with damp cloths.

▲ CAUTION

- **KEEP WATER AWAY FROM BATTERY COMPARTMENT WHILE WASHING TO AVOID DAMAGING THE ELECTRICAL COMPONENTS.**
- **DO NOT CLEAN WITH ALCOHOL, GASOLINE, ACETONE, OR OTHER CORROSIVE/VOLATILE SOLVENTS. THESE SUBSTANCES MAY DAMAGE THE EXTERNAL AND INTERNAL STRUCTURE OF YOUR PRODUCT.**
- **DO NOT RUB WITH SANDPAPER OR METAL BRUSH.**

11.4 CLEAN THE BATTERY AND BATTERY CHARGER

▲ WARNING

DO NOT CLEAN THE BATTERY OR THE BATTERY CHARGER WITH WATER.

- Make sure that the battery, the battery charger, and the battery compartment are all clean and dry.
- Clean the battery terminals with a soft and dry cloth.
- Clean the surface of the battery and the battery charger with a soft and dry cloth.

11.5 REPLACE THE SCRAPER

1. Place the product on a flat, level surface.
2. Remove the 5 screws below the impeller that attach the scraper to the product.

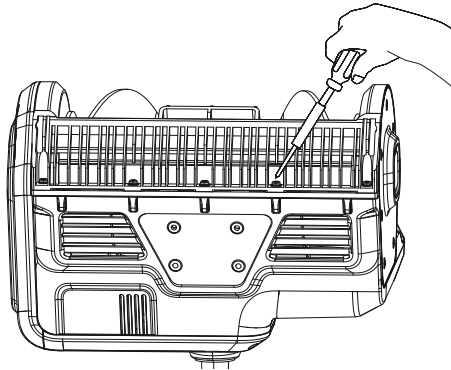

3. Remove 1 screw on the left side cover. Also, remove 1 screw on the right side cover.

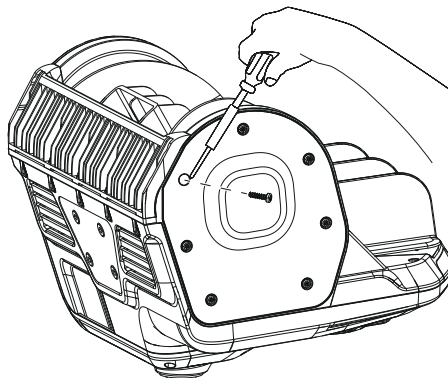
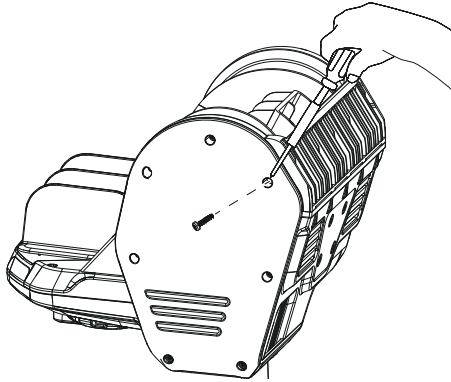

4. Remove the worn scraper.

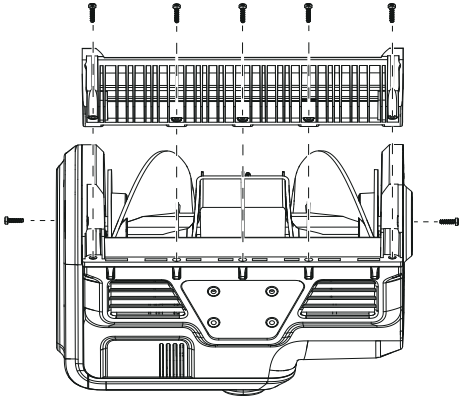

- 5. Install the new scraper.
- 6. Insert and securely tighten the 7 screws.

11.6 REPLACE THE IMPELLER

- 1. Remove the 7 screws on the right side cover.

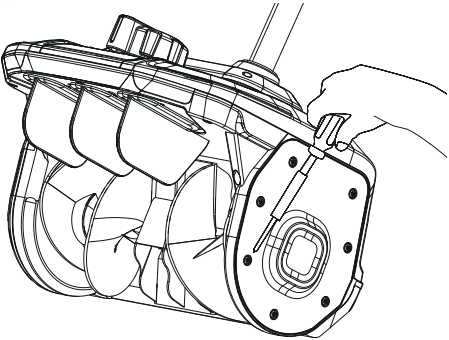

- 2. Remove the nut on the right side plate.

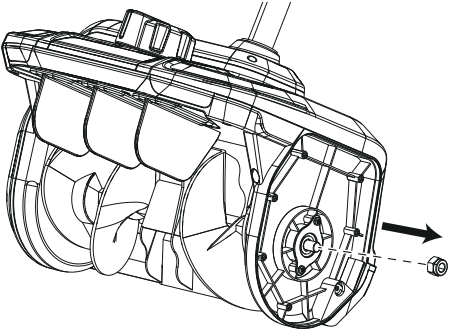

- 3. Remove the 7 screws on the left side cover.

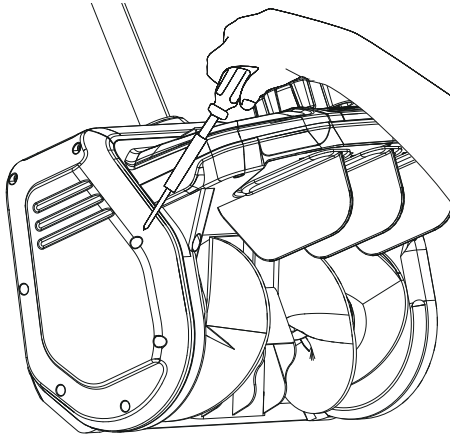

4. Pull the belt tensioner away from the engine pulley. Do not lose or misplace the washer, spring and screw.

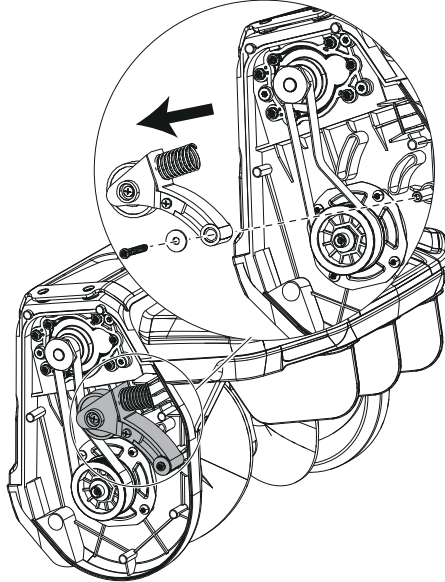

5. Remove the belt.

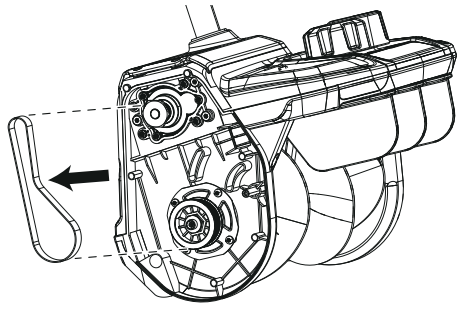

6. Remove the 4 screws that secure the fixed plate.

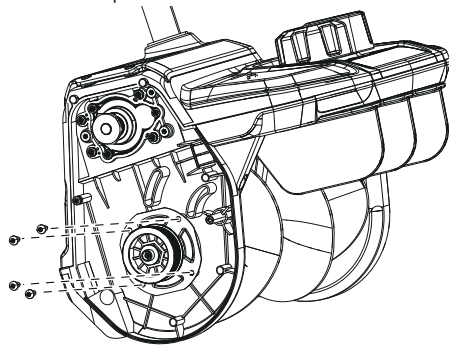

7. Remove the impeller shaft, pulley assembly and fixed plate together.

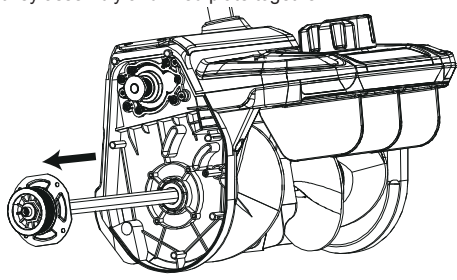

8. Remove the damaged impeller. Do not lose or misplace the small shaft sleeve from the right side of the shaft.

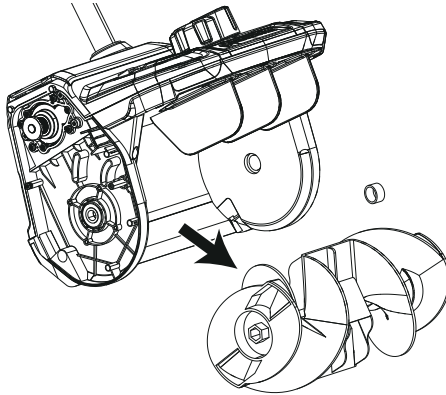

9. Insert the impeller shaft, pulley assembly and the fixed plate through the new impeller. Make sure to install the small shaft sleeve on the right side of the shaft.

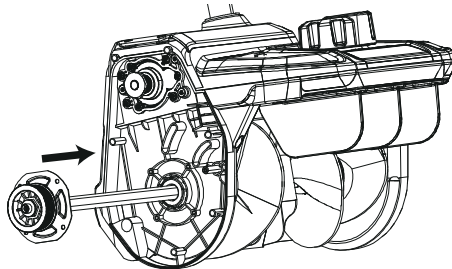

10. Mount and securely tighten the nut on the right side plate assembly. Mount the right side cover, then insert and securely tighten the 7 screws.

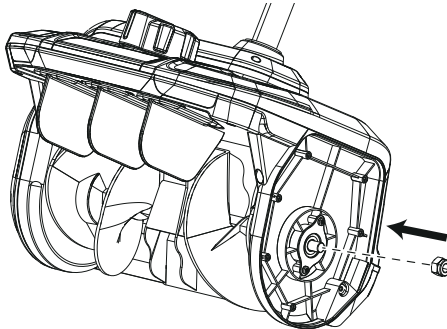

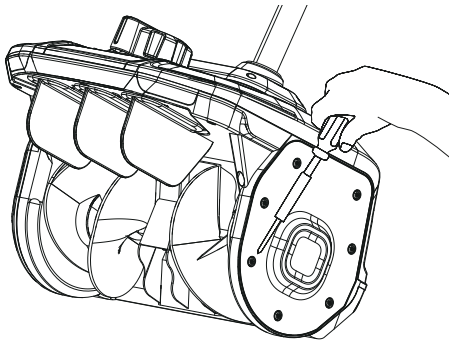

11. Insert and securely tighten the 4 screws on the fixed plate.

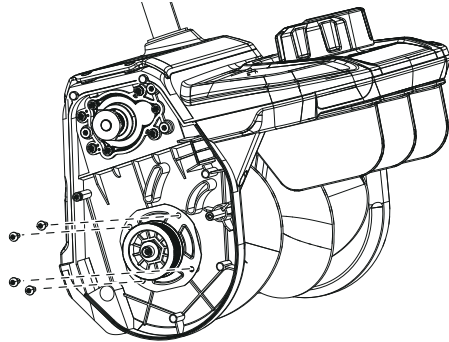

12. Install the belt and the belt tensioner.

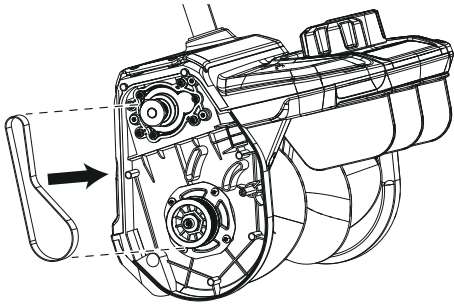

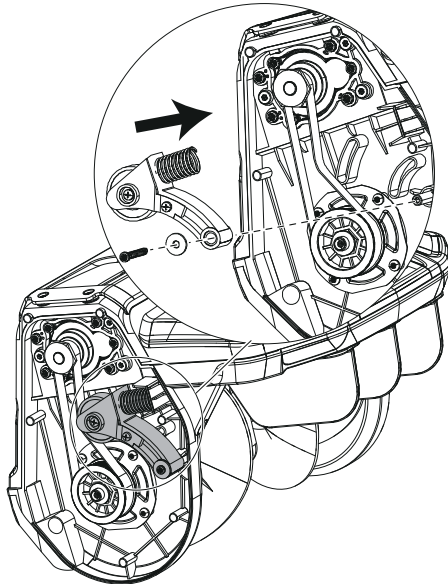

13. Insert and securely tighten the 7 screws on the left side cover.

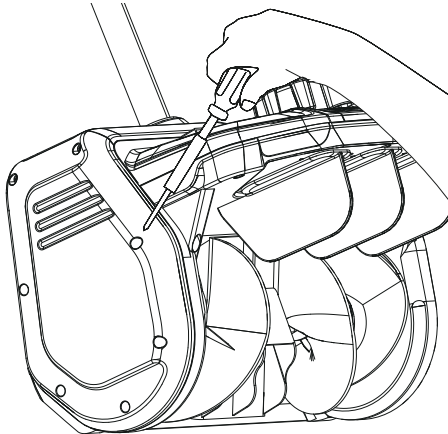

12 TRANSPORTATION, STORAGE, AND DISPOSAL

12.1 TRANSPORTATION

- Any removable (electronic) parts, such as the charger and battery, should always be disconnected before transport.
- Avoid transporting the product in bad weather conditions.
- Make sure to adequately cover any exposed electronic parts if transportation in adverse weather conditions is unavoidable.
- Use tape on open contacts of the battery and ensure it is securely stowed to prevent movement.
- High speeds, along with wind and rain, may force moisture into the electronic components, which can lead to temporary malfunctions or permanent defects.

- In case of malfunction occurring after transport in such conditions, remove the battery and allow all parts to air-dry when you reach your destination.

12.2 DISPOSAL OF THE BATTERY, BATTERY CHARGER, AND PRODUCT

Symbols on the product or the package of the product mean that the product is not domestic waste. Recycle it at a recycling station for electrical and electronic equipment. This helps to prevent damage to the environment and to persons.

Get in touch with your local authorities, domestic waste service, or your dealer for more information about how to recycle your product.

13 TROUBLESHOOTING

Problem	Possible cause	Solution
The handle is not in position.	The bolts are not engaged correctly.	Adjust the height of the handle and make sure that the knobs and bolts are aligned correctly.
The machine does not start.	The battery is not charged.	Charge the battery by following the procedures in the battery and charger manual.
	The switch is defective.	Have the switch replaced by an authorized service center.
	Battery is too cold.	Remove battery from the snow shovel. Place battery on charger and allow to charge for 10 minutes or until the changing light turns green. Remove from charger and install in snow shovel for use.
	Battery may require service or replacement.	Call toll free helpline, at 1-855-345-3934 or replace battery.
The product is on, but the impeller does not turn.	The belt is damaged.	Replace the belt.
A thin layer of snow stays behind.	The scraper bar is damaged.	Replace the scraper bar.

* If you cannot find the solution to these problems, call 1-855-345-3934.

14 TECHNICAL DATA

Model	2600041
Voltage	80 V 
No load speed	1500 / 1800 RPM
Clearing width	12 in (30 cm)
Clearing depth	8 in. (20.3 cm)
Impeller size	11 in (27.8 cm)
Battery	BAB740 and other BAB series
Charger	GCH8020 and other CAB series

Model	SS80L02 (2618402)
Voltage	80 V 
No load speed	1500 / 1800 RPM
Clearing width	12 in (30 cm)
Clearing depth	8 in. (20.3 cm)
Impeller size	11 in (27.8 cm)
Battery	BAB series
Charger	CAB series

Model	SS80L2510 (2618202)
Voltage	80 V 
No load speed	1500 / 1800 RPM
Clearing width	12 in (30 cm)
Clearing depth	8 in. (20.3 cm)
Impeller size	11 in (27.8 cm)
Battery	BAB741 and other BAB series
Charger	GCH8020 and other CAB series

Model	SS80L251CO (2618002)
Voltage	80 V 
No load speed	1500 / 1800 RPM
Clearing width	12 in (30 cm)
Clearing depth	8 in. (20.3 cm)
Impeller size	11 in (27.8 cm)
Battery	BAB742 and other BAB series
Charger	CAB813 and other CAB series

15 LIMITED WARRANTY

90-Day Warranty

Renewed/Refurbished products and batteries are protected against all defects in materials, parts or workmanship under normal use for a period of 90 days from the shipping date or in-store purchase date. All sales are final, no returns.

15.1 ITEMS NOT COVERED BY WARRANTY

- Any part that has become inoperative due to misuse, commercial use, abuse, neglect, accident, improper maintenance, or alteration.
- The unit, if it has not been operated and/or maintained in accordance with the operator manual.
- Normal wear, except as noted below:
 - Routine maintenance items such as lubricants.
 - Normal deterioration of the exterior finish due to use or exposure.

- Any part/product, that has become inoperative due to use with any non-**Greenworks** - branded parts or batteries/chargers.

15.2 HELPLINE

Warranty service is available by calling our toll-free helpline at: 1-855-345-3934.

15.3 SHIPPING

Transportation charges for the movement of any power equipment unit or attachment are the responsibility of the purchaser. It is the purchaser's responsibility to pay transportation charges for any part submitted for replacement under this warranty unless such return is requested in writing by **Greenworks**.

15.3.1 ADDRESS

USA address:

Greenworks Tools

P.O. Box 1238, Mooresville, NC 28115

Canada address:

Greenworks Tools Canada, Inc.

P.O. Box 93095, Newmarket, Ontario, L3Y 8K3

greenworks[®]

www.greenworkstools.com

