

greenworks®

EN

BLOWER

OPERATOR MANUAL

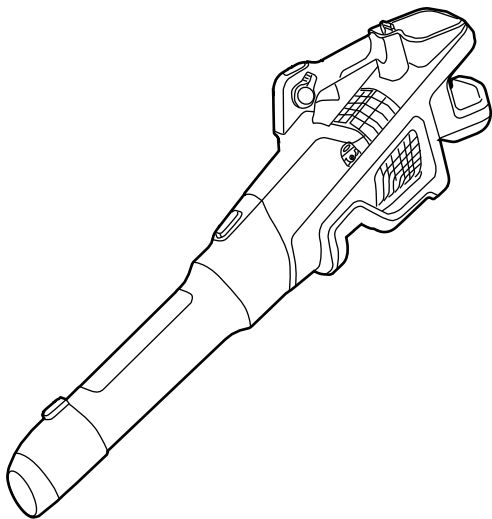

ITM. / ART. 1847759, 688601

BLB479

www.greenworkstools.com

1	Introduction.....	4	5	Maintenance.....	9
1.1	Product description.....	4	5.1	Maintenance schedule.....	9
1.2	Intended use.....	4	5.2	Check the air intake vent.....	9
1.3	Product overview.....	4	5.3	Examine the battery and the battery charger.....	10
1.4	Symbols on the product.....	4	5.4	Clean the product.....	10
1.5	California Proposition 65.....	4	5.5	Clean the battery and battery charger.....	10
2	Safety.....	4	6	Transportation, storage and disposal.....	11
2.1	Safety definitions.....	4	6.1	Transportation.....	11
2.2	Important safety instructions.....	5	6.2	Storage.....	11
2.3	Battery-operated power tools.....	5	6.3	Disposal of the battery, battery charger, and product.....	11
2.4	Child safety.....	6	7	Troubleshooting.....	11
2.5	Save these instructions.....	6	8	Technical data	11
3	Assembly.....	6	9	Limited warranty.....	12
3.1	Install the blower tube.....	6	9.1	Items not covered by warranty.....	12
4	Operation.....	6	9.2	Helpline.....	12
4.1	Before you use the product.....	7	9.3	Shipping.....	12
4.2	Start the product.....	7			
4.3	Activate turbo boost (temporary increased airflow).....	7			
4.4	Activate cruise control (sustained airflow).....	7			
4.5	Stop the product.....	8			

1 INTRODUCTION

1.1 PRODUCT DESCRIPTION

This product is a battery-operated blower with an electric motor.

We are committed to continuously improving our products and reserve the right to modify the design and appearance without prior notice.

1.2 INTENDED USE

The product is designed for clearing leaves, debris, and other materials from various surfaces such as lawns, driveways, pathways, and outdoor spaces.



IMPORTANT

RETAIN FOR FUTURE REFERENCE: READ CAREFULLY. THIS ITEM IS INTENDED FOR OUTDOOR DOMESTIC USE ONLY. NOT FOR COMMERCIAL USE.

1.3 PRODUCT OVERVIEW

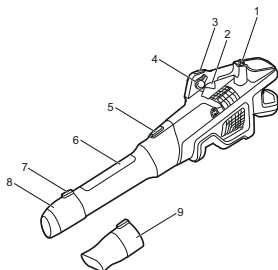

- | | |
|--------------------------|-------------------------|
| 1 Battery release button | 6 Blower tube |
| 2 Trigger | 7 Nozzle release button |
| 3 Turbo boost button | 8 Tapered nozzle |
| 4 Cruise control lever | 9 Concentrator nozzle |
| 5 Tube release button | |

1.4 SYMBOLS ON THE PRODUCT

Symbol	Explanation
V	Voltage
A	Current

Symbol	Explanation
W	Power
min	Time
/min	Revolutions, strokes, surface speed, orbits etc., per minute
---	Direct current
	Carefully read and understand instructions before operating the product and follow all warnings and safety instructions.
	Important safety precautions.
	Use ear protection when operating this product.
	Always wear eye protection with side shields marked to comply with ANSI Z87.1 when operating this product.
	Do not expose the product to rain or moist conditions.
	Keep all bystanders at least 50 ft (15m) away from the work area.
	Do not touch the fan or impeller blades when you operate this product.
	Keep loose clothing, jewelry, and accessories away from the air intake vent.
	Keep long hair away from the air intake vent.
	Do not touch. Rotating blades can cause severe injury.

1.5 CALIFORNIA PROPOSITION 65

WARNING

THIS PRODUCT CONTAINS OR EMITS A CHEMICAL KNOWN TO THE STATE OF CALIFORNIA TO CAUSE CANCER OR BIRTH DEFECTS OR OTHER REPRODUCTIVE HARM.

2 SAFETY

2.1 SAFETY DEFINITIONS

Warnings, cautions, and notes are used to point out especially important parts of the manual.

 WARNING

THERE IS A RISK OF INJURY OR DEATH FOR THE OPERATOR OR BYSTANDERS IF THE INSTRUCTIONS IN THE MANUAL ARE NOT OBEYED.

 CAUTION

THERE IS A RISK OF DAMAGE TO THE PRODUCT, OTHER MATERIALS, OR THE ADJACENT AREA, IF THE INSTRUCTIONS IN THE MANUAL ARE NOT OBEYED.

Note: Used to give more information that is necessary in a given situation.

2.2 IMPORTANT SAFETY INSTRUCTIONS

For household use.

READ ALL INSTRUCTIONS BEFORE USING (THIS POWER TOOL) WARNING

READ AND UNDERSTAND ALL INSTRUCTIONS BEFORE USING THIS PRODUCT. FAILURE TO FOLLOW ALL INSTRUCTIONS LISTED BELOW MAY RESULT IN ELECTRIC SHOCK, FIRE, AND/OR SERIOUS PERSONAL INJURY. WHEN USING AN ELECTRICAL APPLIANCE, BASIC PRECAUTIONS SHOULD ALWAYS BE FOLLOWED, INCLUDING THE FOLLOWING:

- Do not use on wet surfaces.
- Do not charge the unit outdoors.
- Do not allow to be used as a toy. Close attention is necessary when used by or near children.
- Use only as described in this manual. Use only manufacturer's recommended attachments.
- If appliance is not working as it should, has been dropped, damaged, left outdoors, or dropped into water, return it to a service center.
- Do not handle appliance with wet hands.
- Do not put any object into openings. Do not use with any opening blocked; keep free of dust, lint, hair, and anything that may reduce air flow.
- Keep hair, loose clothing, fingers, and all body parts away from openings and moving parts.
- Use extra care when cleaning on stairs.
- Do not operate power tools in an explosive atmosphere, such as in the presence of flammable liquids, gases, or dust. Power tools create sparks that may ignite the dust or fumes.
- Never allow children to operate the equipment. Never allow adults to operate the equipment without proper instruction.

- Wear heavy long pants, boots, and gloves. Avoid loose garments or jewelry that could get caught in moving parts of the machine or its motor.
- Do not force tool. Use the correct tool for your application. The correct tool will do the job better and safer at the rate for which it is designed.
- Keep firm footing and balance. Do not overreach. Overreaching can result in loss of balance.
- Do not use the tool if the switch does not turn it on or off. Any tool that cannot be controlled with the switch is dangerous and must be repaired.
- Do not operate this unit when you are tired, ill, or under the influence of alcohol, drugs, or medication.
- Do not operate in poor lighting.
- Do not use to pick up flammable or combustible liquids, such as gasoline, or use in areas where they may be present.
- Do not pick up anything that is burning or smoking, such as cigarettes, matches, or hot ashes.
- Do not use without dust bag and/or filters in place (if applicable).
- Check the work area before each use. Remove all objects such as rocks, broken glass, nails, wire, or string which can be thrown or become entangled in the machine.
- Use only identical manufacturer's replacement parts and accessories. Use of any other parts may create a hazard or cause product damage.
- To Reduce The Risk Of Electric Shock – Do Not Expose To Rain – Store Indoors.
- Use only with BAB742, BAB741 and other BAB battery packs.
- Use only with GCH8020 and other CAB chargers.

2.3 BATTERY-OPERATED POWER TOOLS

- Do not use battery-operated appliance in rain.
- Turn off all controls before removing the battery.
- Recharge only with the charger specified by the manufacturer. A charger that is suitable for one type of battery pack may create a risk of fire when used with another battery pack.
- Use only the charger supplied by the manufacturer to recharge.
- Use appliances only with specifically designated battery packs. Use of any other battery packs may create a risk of injury and fire.
- Prevent unintentional starting. Ensure the switch is in the off position before connecting to battery pack, picking up or carrying the appliance. Carrying the power tool with your finger on the switch may create a risk of injury.
- Disconnect the battery pack from the power tool before making any adjustments, changing accessories, or storing the power tool. Such preventive safety measures reduce the risk of starting the power tool accidentally.

- When battery pack is not in use, keep it away from other metal objects like paper clips, coins, keys, nails, screws, or other small metal objects that can make a connection from one terminal to another. Shorting the battery terminals together may cause burns or a fire.
- Under abusive conditions, liquid may be ejected from the battery; avoid contact. If contact accidentally occurs, flush with water. If liquid contacts eyes, additionally seek medical help. Liquid ejected from the battery may cause irritation or burns.
- Do not incinerate the appliance even if it is severely damaged. The batteries can explode in a fire.
- Do not use a battery pack or appliance that is damaged or modified. Damaged or modified batteries may exhibit unpredictable behavior resulting in fire, explosion, or risk of injury.
- Do not expose a battery pack or appliance to fire or excessive temperature. Exposure to fire or temperature above 265°F (130°C) may cause an explosion.
- Unit should only be serviced by a qualified repair technician using only Greenworks replacement parts. This will prolong the life of the unit and maintain product safety.
- Don't modify or attempt to repair the appliance or the battery pack (as applicable) except as indicated in the instructions for use and care.
- Follow all charging instructions and do not charge the battery pack or appliance outside of the temperature range specified in the instructions. Charging improperly or at temperatures outside of the specified range may damage the battery and increase the risk of fire.

2.4 CHILD SAFETY

Tragic accidents can occur if the operator is not aware of the presence of children.

- Keep children out of the working area and under the watchful care of a responsible adult.
- Do not allow children under the age of 14 to operate this machine. Children who are 14 years of age and older must read and understand the operating instructions and safety rules in this manual and must be trained and supervised by a parent.
- Stay alert and turn the machine off if a child or any other person enters the working area.
- Use extreme care when approaching blind corners, doorways, shrubs, trees, or other objects that may obscure your view of a child who may run into the path of the machine.

2.5 SAVE THESE INSTRUCTIONS

3 ASSEMBLY

This section describes how to assemble and adjust the product.

⚠ WARNING

CAREFULLY READ AND UNDERSTAND THE SAFETY CHAPTER AND THE ASSEMBLY INSTRUCTIONS BEFORE YOU ASSEMBLE THE PRODUCT.

3.1 INSTALL THE BLOWER TUBE

1. Attach the blower tube to the tubular end of the product until the tube release button clicks into place.

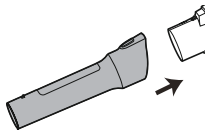

Note: Ensure that the blower tube is securely attached to the tubular end before starting the product.

2. Choose a nozzle.
3. To achieve higher airspeed, attach the tapered nozzle or concentrator nozzle to the blower tube until it clicks into place.

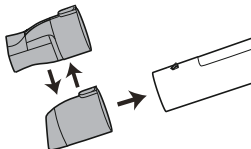

Note: Make sure that the nozzle and the blower tube are securely attached before starting the product.

4 OPERATION

This section describes how to operate the product.

⚠ WARNING

CAREFULLY READ AND UNDERSTAND THE SAFETY CHAPTER AND OPERATION INSTRUCTIONS BEFORE YOU OPERATE THE PRODUCT.

4.1 BEFORE YOU USE THE PRODUCT

4.1.1 CONNECT THE BATTERY CHARGER

1. Connect the battery charger to the proper voltage and frequency that is specified on the rating plate.
2. Refer to the Battery Charger Operator Manual for information about how to use the battery charger.

4.1.2 CHARGE THE BATTERY

Refer to the Battery Charger Operator Manual for information about how to use the battery charger.

4.1.3 BATTERY INFORMATION

Refer to the Battery Operator Manual for information about how to use the battery.

4.1.4 CONNECT THE BATTERY TO THE PRODUCT



WARNING

ONLY USE GREENWORKS ORIGINAL BATTERIES WITH THE PRODUCT.

1. Make sure that the battery is fully charged.
2. Push the battery into the battery compartment. The battery locks into position when you hear a click.

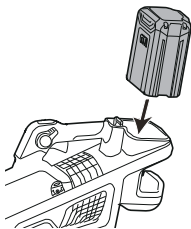

CAUTION

IF THE BATTERY DOES NOT MOVE EASILY INTO THE BATTERY COMPARTMENT, THE BATTERY IS NOT INSTALLED CORRECTLY. THIS CAN CAUSE DAMAGE TO THE PRODUCT.

3. Make sure that the battery is installed correctly.

4.2 START THE PRODUCT

1. Pull the trigger to start the product.

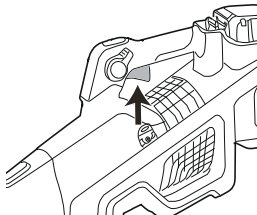

2. The variable speed trigger delivers higher air speed with increased trigger pressure and lower air speed with decreased trigger pressure.

4.3 ACTIVATE TURBO BOOST (TEMPORARY INCREASED AIRFLOW)

1. Pull the trigger to start the product.
2. Push the turbo boost button to engage the maximum airflow.

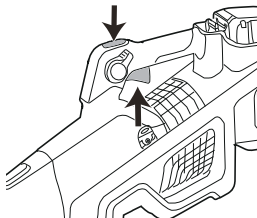

3. Release the turbo boost button to operate the product with the default airflow setting.

Note: Using the turbo boost button will result in faster battery consumption. Exercise caution and only activate the turbo boost when necessary.

4.4 ACTIVATE CRUISE CONTROL (SUSTAINED AIRFLOW)

1. Pull the trigger to start the product and select the optimal airflow for your work.

2. Rotate the cruise control lever clockwise to sustain the selected airflow.

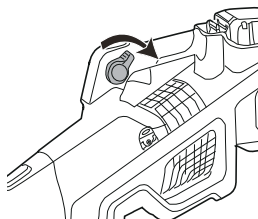

Note: Rotate the cruise control lever clockwise to increase the speed. Pull the cruise control lever counterclockwise to decrease or disengage completely.

4.5 STOP THE PRODUCT

1. Release the trigger.
2. Push and hold the battery release button.
3. Remove the battery from the product to fully stop its operation.

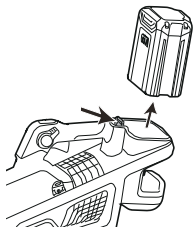

5 MAINTENANCE

 IMPORTANT

Carefully read and understand the safety regulations and the maintenance instructions before you clean, repair, or do any maintenance on the product (Reference Safety regulations and maintenance instructions).

 WARNING

- REMOVE BATTERY OR BATTERIES FROM THE PRODUCT BEFORE YOU DO ANY MAINTENANCE.
- FAILURE TO FOLLOW PROPER MAINTENANCE SERVICE, USING THIRD-PARTY REPLACEMENT PARTS, OR MODIFYING/REMOVING COMPONENTS CAN RESULT IN INJURY TO THE USER.

5.1 MAINTENANCE SCHEDULE

The following is a list of the maintenance steps that must be performed on the product.

Maintenance	Daily	Weekly	Monthly
Clean the outside of the product with a clean and dry cloth. Never use water.	X		
Keep handles dry, clean, and free from oil and grease.	X		
Make sure the trigger is functioning properly.	X		
Check that nuts and screws are tight.	X		
Check that the battery is intact.	X		
Check the battery's charge.	X		
Check that the release button works and locks the battery into place.	X		
Check that the battery charger is intact and functioning properly.	X		
Inspect all couplings, connections, and cables for any damage or dirt.		X	
Check the connections between the battery and the product, as well as the connection between the battery and the battery charger.			X

5.2 CHECK THE AIR INTAKE VENT

 CAUTION

A BLOCKED AIR INTAKE VENT AND/OR BLOCKED IMPELLER DECREASES THE BLOWING CAPACITY OF THE PRODUCT AND INCREASES THE WORKING TEMPERATURE OF THE MOTOR. IF THE MOTOR BECOMES TOO HOT, IT CAN RESULT IN MOTOR FAILURE.

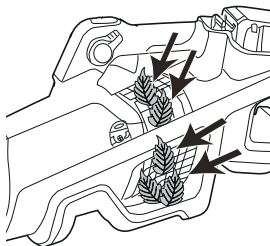

1. Ensure that the air intake vent is not blocked.
2. If necessary, stop the product and remove any leaves or debris from the air intake vent.

5.3 EXAMINE THE BATTERY AND THE BATTERY CHARGER

Carefully inspect the battery, battery charger, and connection cord of the battery charger for any signs of damage, such as cracks or broken parts. Replace if necessary.

5.4 CLEAN THE PRODUCT

CAUTION

- KEEP WATER AWAY FROM BATTERY COMPARTMENT WHILE WASHING TO AVOID DAMAGING THE ELECTRICAL COMPONENTS.
- DO NOT CLEAN WITH ALCOHOL, GASOLINE, ACETONE, OR OTHER CORROSIVE/VOLATILE SOLVENTS. THESE SUBSTANCES MAY DAMAGE THE EXTERNAL AND INTERNAL STRUCTURE OF YOUR PRODUCT.
- DO NOT RUB WITH SANDPAPER OR METAL BRUSH.

Clean the product after each use with water, neutral detergent, and a soft cloth.

5.5 CLEAN THE BATTERY AND BATTERY CHARGER

WARNING

DO NOT CLEAN THE BATTERY OR THE BATTERY CHARGER WITH WATER.

- Make sure that the battery and the battery charger and battery compartment are all clean and dry before you insert the battery into the battery charger.
- Clean the battery terminals with a soft and dry cloth.
- Clean the surface of the battery and the battery charger with a soft and dry cloth.

6 TRANSPORTATION, STORAGE AND DISPOSAL

6.1 TRANSPORTATION

- Any removable (electronic) parts, such as the charger and battery, should always be disconnected before transport.
- Avoid transporting the product in bad weather conditions.
- Make sure to adequately cover any exposed electronic parts if transportation in adverse weather conditions is unavoidable.
- Use tape on open contacts of the battery and ensure it is securely stowed to prevent movement.
- High speeds, along with wind and rain, may force moisture into the electronic components, which can lead to temporary malfunctions or permanent defects.
- In case of malfunction occurring after transport in such conditions, remove the battery and allow all parts to air-dry when you reach your destination.

6.2 STORAGE

If the product is left unused for an extended period, proper storage maintenance is required.

- Store the product locked up to prevent unauthorized use or damage.
- Store the product in a dry, well-ventilated area.
- Store the product out of the reach of children.

6.3 DISPOSAL OF THE BATTERY, BATTERY CHARGER, AND PRODUCT

Symbols on the product or the package of the product mean that the product is not domestic waste. Recycle it at a recycling station for electrical and electronic equipment. This helps to prevent damage to the environment and persons.

Get in touch with your local authorities, domestic waste service, or your dealer for more information about how to recycle your product.

7 TROUBLESHOOTING

PROBLEM	POSSIBLE CAUSE	POSSIBLE SOLUTION
The product does not start.	The battery is not installed tightly.	Make sure that you securely inset the battery in the product.
	The battery is out of power.	Charge the battery.
	The switch is defective.	Replace the defective parts through an authorized service center.
	The motor is defective.	
The PCB board is defective.		
The air does not flow through the tube when you start the product.	The air inlet or tube outlet has a blockage.	Carefully remove the blockage.

8 TECHNICAL DATA

Voltage	80V DC
Air volume	800 CFM (0.38 m ³ /s)
Air speed	200 MPH (89.4 m/s)
Battery model	BAB742, BAB741 and other BAB series
Charger model	GCH8020 and other CAB series

The recommended ambient temperature ranges:

Situation	Temperature
Product storage	32 °F (0 °C) ~ 113 °F (45 °C)
Product operation	32 °F (0 °C) ~ 113 °F (45 °C)
Battery charging	39 °F (4 °C) ~ 104 °F (40 °C)
Charger operation	39 °F (4 °C) ~ 104 °F (40 °C)
Battery storage	32 °F (0 °C) ~ 113 °F (45 °C)
Battery discharging	32 °F (0 °C) ~ 113 °F (45 °C)

9 LIMITED WARRANTY

90-Day Warranty

Renewed/Refurbished products and batteries are protected against all defects in materials, parts or workmanship under normal use for a period of 90 days from the shipping date or in-store purchase date. All sales are final, no returns.

9.1 ITEMS NOT COVERED BY WARRANTY

- Any part that has become inoperative due to misuse, commercial use, abuse, neglect, accident, improper maintenance, or alteration.
- The unit, if it has not been operated and/or maintained in accordance with the operator manual.
- Normal wear, except as noted below:
 - Routine maintenance items such as lubricants.
 - Normal deterioration of the exterior finish due to use or exposure.
 - Any part/product, that has become inoperable due to use with any non-**Greenworks** - branded parts or batteries/chargers.

9.2 HELPLINE

Warranty service is available by calling our toll-free helpline at: 1-855-345-3934.

9.3 SHIPPING

Transportation charges for the movement of any power equipment unit or attachment are the responsibility of the purchaser. It is the purchaser's responsibility to pay transportation charges for any part submitted for replacement under this warranty unless such return is requested in writing by **Greenworks**.

9.3.1 ADDRESS

USA address:

Greenworks Tools

P.O. Box 1238, Mooresville, NC 28115

Canada address:

Greenworks Tools Canada, Inc.

P.O. Box 93095, Newmarket, Ontario, L3Y 8K3

Mexico address:

Importadora Primex S.A. de C.V.

Blvd. Magnocentro No.4 San Fernando La Herradura
Huixquilucan, Estado de México C.P. 52765

Distributed by:
Costco Wholesale Corporation
P.O. Box 34535
Seattle, WA 98124-1535
USA
1-800-774-2678
www.costco.com

Importado por:
Importadora Primex S.A. de C.V.
Blvd. Magnocentro No. 4
San Fernando La Herradura
Huixquilucan, Estado de México
C.P. 52765
RFC: IPR-930907-S70
(55)-5246-5500
www.costco.com.mx

greenworks[®]

www.greenworkstools.com



P0806050-00